

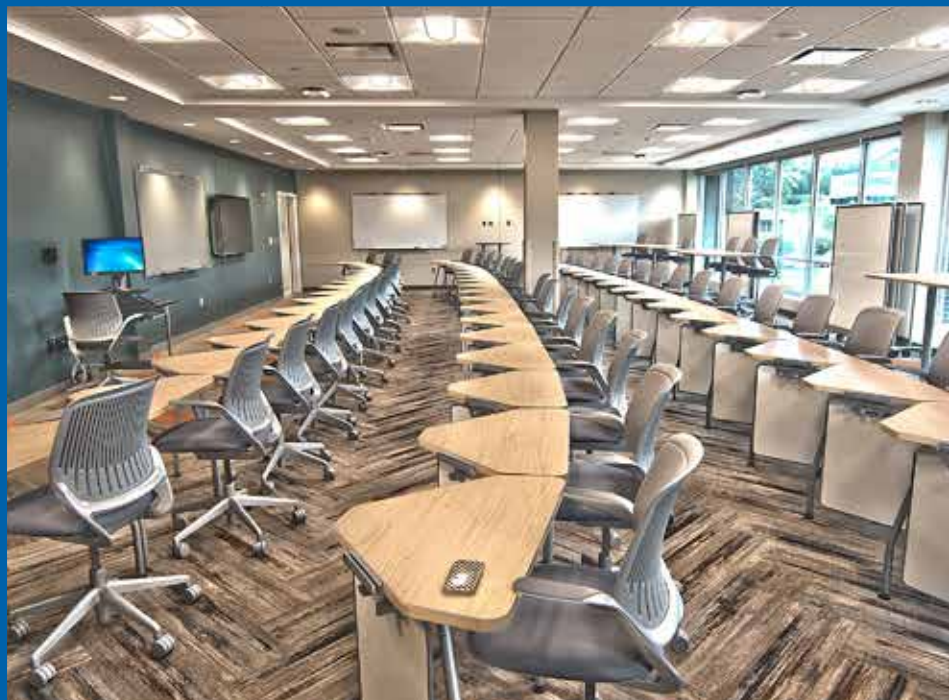

the Power to Create Better Light™



OEM PRODUCT GUIDE



www.espentech.com

THE
POWER
TO CREATE
BETTER
LIGHT



INTRODUCTION

LED
MODULES

Who is Espen Technology?

LED
DRIVERS

We at Espen Technology focus on transforming how our world uses light. As a manufacturer we are dedicated to delivering **sustainable** and **environmentally** progressive lighting solutions. Our product reflect an emphasis on sustainability, quality and reliability.

LED
DRIVER CASES

With over **30 years** of manufacturing experience and knowledge, our engineers understand the importance of producing reliable products. From stringent component qualification standards to the extensive testing done to all our products before shipping, quality is our top priority. Our products are complemented by an industry-leading warranty policy.

LED
LAMPS

Headquartered in Southern California, our customer service and technical support teams provide full service. With manufacturing facilities and R&D teams across the world, we are committed to developing innovative products with reliability, utility and efficiency in mind.

VERSALINEAR™
RETROFIT KITS

Finding the **perfect balance of innovation and practicality is Espen's forte.**

LED EMERGENCY
BATTERY BACKUP

MISSION STATEMENT

Commitment to Value

To proliferate high performance lighting products and solutions at an unbeatable value. Become the market leader by delivering reliable and high quality LED products and System solutions.

Ultimately our mission is to give our customers, contractors and end-users the power to create better light through quality, value, and energy-saving technology.

STEP-DOWN
TRANSFORMERS

CONTROL
OPTIONS

TABLE OF CONTENTS

Certification Information.....	1
LED MODULES.....	2
versaLinear™ Aluminum Base LED Modules.....	2
Standard LED Modules.....	5
LED DRIVERS.....	8
Constant Current.....	8
intelli LUX™ Selectable Current & CCT.....	15
Constant Power.....	19
Constant Voltage.....	23
LED Driver Case Drawings.....	26
LED LAMPS.....	32
Type B LED Lamps.....	32
Flex™ LED 360° Sign Lamps.....	40
Flex™ HID Replacement Lamps.....	41
CORETECH™ LED Type C LED Lamps.....	42
LED RETROFIT KITS.....	48
versaLinear™ LED Module & Driver Kits.....	48
LED EMERGENCY BATTERY BACK UP.....	51
Self Contained Emergency Kits.....	51
2 Piece Emergency Systems.....	52
Emergency Inverters.....	53
STEP-DOWN TRANSFORMERS.....	54
CONTROL OPTIONS.....	56
versaDim™ RF Adapter.....	56
Occupancy Sensor.....	57

LED
MODULES

LED
DRIVERS

LED
DRIVER CASES

LED
LAMPS

LED
RETROFIT KITS

LED EMERGENCY
BATTERY BACK UP

STEP-DOWN
TRANSFORMERS

CONTROL
OPTIONS

CERTIFICATION INFORMATION

LED
MODULES

UL-P Certification from UL allowing for Lighting Fixture Manufacturers to directly replace similar LED drivers into fixtures previously certified through UL without having to re-submit the fixture to UL for certification. Max power ratings of the fixture cannot be exceeded. Allows for greater flexibility for fixture manufacturers to source component parts.

cUL The cUL mark applies to products intended for the Canadian market that have been tested and found to comply with the requirements of CAN/CSA 22.1-12, which is the Canadian Electrical Code issued by the Canadian Standards Association.

LED
DRIVERS

UL UL stands for Underwriters Laboratories in the United States, and the initials UL represent their mark of approval. The UL label on electrical products indicates that the products have been tested to be in accordance with safety standards by Underwriters Laboratories.

UR The UL Recognized Component Mark means that the product has been tested as a component. These components will later be used in complete end-products or systems.

CSA Now CSA Group is a Canadian Certification that basically serves North America and includes testing to American National Standards Institute (ANSI), Underwriters Laboratories (UL), CSA Group (CSA), NSF International (NSF) and other global standards as required.

LED
DRIVER CASES

ETL Electrical Testing Laboratories (ETL), ETL does not publish their own safety standards. ETL tests products to the standards published by other NRTLs. Products are held to the same standards as UL and are also recognized by OSHA.

UL8750 ANSI/UL 8750 covers LED equipment that is an integral part of a luminaire or other lighting equipment. The standard also applies to the component parts of LED equipment, including LED drivers, controllers, arrays, modules, and packages.

LED
LAMPS

SAM The Sign Component Manual (also known as the SAM) contains all the major components associated with the construction of electric signs including LED modules, LED power supplies (drivers) and controllers. Components and accessories in the SAM are evaluated to comply with UL879, Standard for Electric Sign Components. The SAM is designed to be a buyer's guide for electric signs. Any manufacturer who wants to build signs and streamline their UL certification process will pick from components already included in the SAM.

IP Ratings Ingress Protection determines to what level an electrical product's exterior case or enclosure will protect the working parts from water, dust or solid object intrusion, keeping the product electrically safe and lasting longer. Ingress protection testing, or IP testing, provides a repeatable test standard to compare the enclosure protection; IP testing should always be performed at an accredited test laboratory.

LED
RETROFIT KITS

L70 Measurement of the time it takes a light source to degrade to 70% of its original light output. The light is usually measured in hours and refers to the degradation of total light.

LM79 An LM79 report measures the performance (light) of LED-based luminaires based on specific and collective components which include drive current (mA), CCT (color temperature), watts, efficiency and distribution. LM79 requires complete luminaire testing. It does not cover external operating circuits or external heat sinks (e.g. LED chips, LED packages and LED modules). Uses absolute photometry rather than relative photometry.

LED
EMERGENCY
BATTERY BACKUP

LM80 An LM-80 report measures the first 6000-10000 hours of LED life. It is the IES-approved method of measuring the lumen maintenance of LED packages and modules. Lumen maintenance refers to the number of hours that a light source remains "useful" before its output diminishes to 70%.

TM21 TM-21 establishes a standard way to use LM-80 data to make consistent lifetime projections beyond the testing period. TM-21 dictates which values can be used in the calculation based on the sample size, number of hours and intervals tested, and test suite temperature. TM21 helps in choices between LED retrofit options.

STEP-DOWN
TRANSFORMERS

DLC The DesignLights Consortium (DLC) is similar to the Energy Star program. The goal of the DLC is to promote energy efficient lighting in the building sector by influencing public policy and specifying product performance

TITLE 24 The California Energy Commission's Title 24 regulations outline energy efficiency standards for residential and non-residential buildings. Title 24, also known as the California Building Standards Code, is a broad set of requirements for "energy conservation, green design, construction and maintenance, fire and life safety, and accessibility" that apply to the "structural, mechanical, electrical, and plumbing systems" in a building.

CEC TITLE 20 California Energy Commission Title 20. Mandates efficiency requirements for many items including LED Lamps and LED Emergency BBU Systems

CONTROL
OPTIONS

versaLinear™

LED Modules - Aluminum Base Part Number Break Down

Example part number:

VLM4824CVHO850

VLM	48	24	C	VHO	8	50
↓	↓	↓	↓	↓	↓	↓
Espen Linear LED Module	Length 24 = 22" 36 = 33" 48 = 44"	Wattage 09 - 9W 12 - 12W 13 - 13W 24 - 24W 48 - 48W	Lens type C-Clear F-Frosted	None = Standard Output HO = High Output VHO = Very High Output	CRI 8 - 80 9 - 90	Color Temp 30 - 3000K 35 - 3500K 40 - 4000K 50 - 5000K

FEATURES AND BENEFITS

- Light output from 540 to 1940 lm/ft
- Easy mounting with magnets
- High efficacy up to 162 lm/W
- Long life min. 50000 hours
- Quick connectors underneath
- Fully lit without dark spots on the ends
- UL Recognized components
- UL Classified and DLC listed with drivers in **versaKits™**
- Optional clear or frosted lens



versaLinear™ ALUMINUM BASE LED MODULES

LED
MODULES

11" MODULES

MODEL #	COLOR TEMP	NOMINAL POWER (W)	MAX POWER (W)	VF	NOMINAL CURRENT (mA)	MAX CURRENT (mA)	NOMINAL LUMENS	MAX LUMENS	CRI	NOMINAL EFFICACY (LPW)	MAX EFFICACY (LPW)	STOCK STATUS
VLM1209F/830	3000K	9	10.8	30	300	360	990	1242	80	110	115	SO
VLM1209F/835	3500K	9	10.8	30	300	360	1000	1255	80	111	116	SO
VLM1209F/840	4000K	9	10.8	30	300	360	1055	1325	80	117	122	SO
VLM1209F/850	5000K	9	10.8	30	300	360	1220	1380	80	122	128	SO

LED
DRIVERS

11" HO MODULES

MODEL #	COLOR TEMP	NOMINAL POWER (W)	MAX POWER (W)	VF	NOMINAL CURRENT (mA)	MAX CURRENT (mA)	NOMINAL LUMENS	MAX LUMENS	CRI	NOMINAL EFFICACY (LPW)	MAX EFFICACY (LPW)	STOCK STATUS
VLM1218F/830	3000K	14.2	18.2	40.6	350	450	2112	2623	80	149	144	SO
VLM1218F/835	3500K	14.2	18.2	40.6	350	450	2158	2679	80	152	147	SO
VLM1218F/840	4000K	14.2	18.2	40.6	350	450	2226	2764	80	157	152	SO
VLM1218F/850	5000K	14.2	18.2	40.6	350	450	2272	2821	80	160	155	SO

LED
DRIVER CASES

22" MODULES

MODEL #	COLOR TEMP	NOMINAL POWER (W)	MAX POWER (W)	VF	NOMINAL CURRENT (mA)	MAX CURRENT (mA)	NOMINAL LUMENS	MAX LUMENS	CRI	NOMINAL EFFICACY (LPW)	MAX EFFICACY (LPW)	STOCK STATUS
VLM2409F/830	3000K	9	10.8	30	300	360	1098	1098	80	122	118	SO
VLM2409F/835	3500K	9	10.8	30	300	360	1110	1110	80	123	119	Stock
VLM2409F/840	4000K	9	10.8	30	300	360	1171	1171	80	130	126	Stock
VLM2409F/850	5000K	9	10.8	30	300	360	1220	1220	80	135	131	Stock

*SO = Special Order

LED
LAMPS

Height of all modules

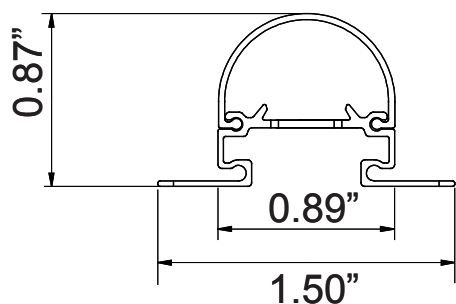

1ft module

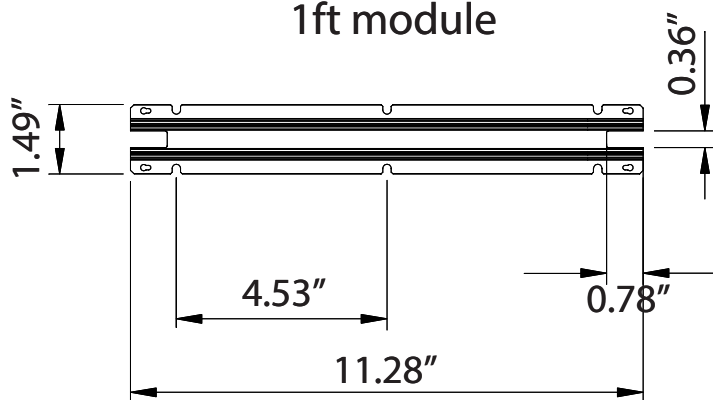

LED
RETROFIT KITS

2ft module

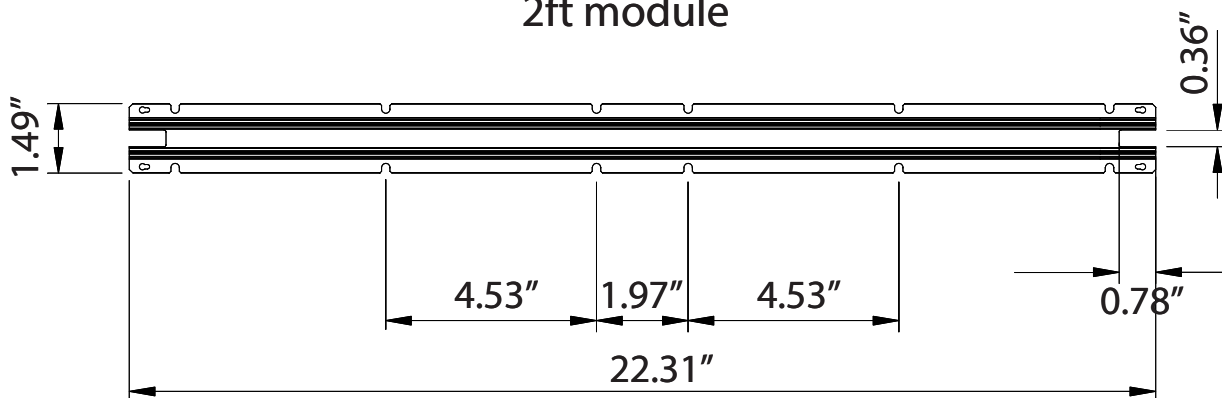

LED
EMERGENCY
BATTERY BACKUP

STEP-DOWN
TRANSFORMERS

CONTROL
OPTIONS

versaLinear™ ALUMINUM BASE LED MODULES

33" MODULES

MODEL #	COLOR TEMP	NOMINAL POWER (W)	MAX POWER (W)	VF	NOMINAL CURRENT (mA)	MAX CURRENT (mA)	NOMINAL LUMENS	MAX LUMENS	CRI	NOMINAL EFFICACY (LPW)	MAX EFFICACY (LPW)	STOCK STATUS
VLM3612F/830	3000K	12.6	15.1	42	300	360	1530	1780	80	122	118	SO
VLM3612F/835	3500K	12.6	15.1	42	300	360	1547	1800	80	123	119	Stock
VLM3612F/840	4000K	12.6	15.1	42	300	360	1632	1899	80	130	126	Stock
VLM3612F/850	5000K	12.6	15.1	42	300	360	1700	1978	80	135	131	Stock

44" MODULES

MODEL #	COLOR TEMP	NOMINAL POWER (W)	MAX POWER (W)	VF	NOMINAL CURRENT (mA)	MAX CURRENT (mA)	NOMINAL LUMENS	MAX LUMENS	CRI	NOMINAL EFFICACY (LPW)	MAX EFFICACY (LPW)	STOCK STATUS
VLM4813F/830	3000K	13.5	16.2	45	300	360	1638	1910	80	122	118	SO
VLM4813F/835	3500K	13.5	16.2	45	300	360	1656	1931	80	123	119	Stock
VLM4813F/840	4000K	13.5	16.2	45	300	360	1747	2037	80	130	126	Stock
VLM4813F/850	5000K	13.5	16.2	45	300	360	1820	2122	80	135	131	Stock

44" HO MODULES

MODEL #	COLOR TEMP	NOMINAL POWER (W)	MAX POWER (W)	VF	NOMINAL CURRENT (mA)	MAX CURRENT (mA)	NOMINAL LUMENS	MAX LUMENS	CRI	NOMINAL EFFICACY (LPW)	MAX EFFICACY (LPW)	STOCK STATUS
VLM4824F/HO/830	3000K	25.2	N/A	42	600	Same as nominal	3078	Same as nominal	80	122	Same as nominal	SO
VLM4824F/HO/835	3500K	25.2	N/A	42	600	Same as nominal	3112	Same as nominal	80	123	Same as nominal	Stock
VLM4824F/HO/840	4000K	25.2	N/A	42	600	Same as nominal	3283	Same as nominal	80	130	Same as nominal	Stock
VLM4824F/HO/850	5000K	25.2	N/A	42	600	Same as nominal	3420	Same as nominal	80	135	Same as nominal	Stock

44" VHO MODULES

MODEL #	COLOR TEMP	NOMINAL POWER (W)	MAX POWER (W)	VF	NOMINAL CURRENT (mA)	MAX CURRENT (mA)	NOMINAL LUMENS	MAX LUMENS	CRI	NOMINAL EFFICACY (LPW)	MAX EFFICACY (LPW)	STOCK STATUS
VLM4848C/VHO/830	3000K	50.4	N/A	42	1200	Same as nominal	6138	Same as nominal	80	122	Same as nominal	SO
VLM4848C/VHO/835	3500K	50.4	N/A	42	1200	Same as nominal	6206	Same as nominal	80	123	Same as nominal	Stock
VLM4848C/VHO/840	4000K	50.4	N/A	42	1200	Same as nominal	6547	Same as nominal	80	130	Same as nominal	Stock
VLM4848C/VHO/850	5000K	50.4	N/A	42	1200	Same as nominal	6820	Same as nominal	80	135	Same as nominal	Stock

*SO = Special Order

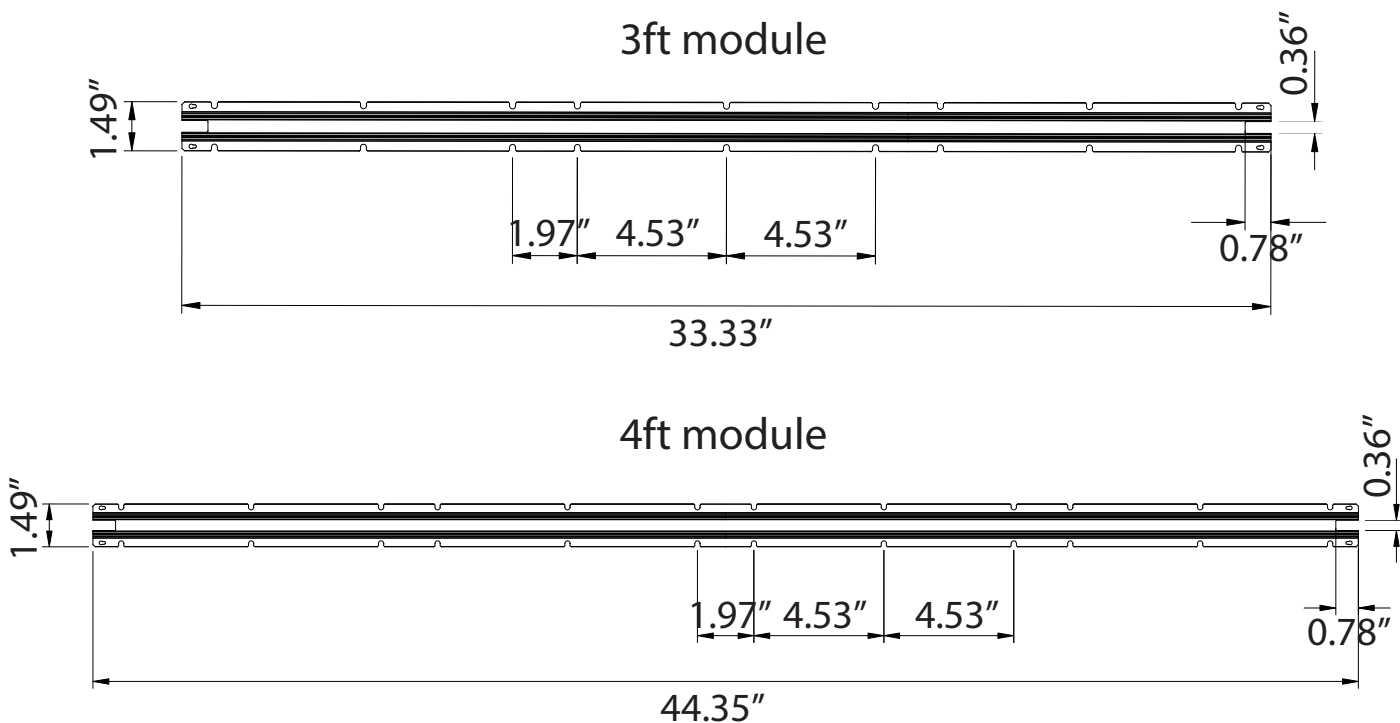

(866) 933.7736 | info@espentech.com

Technical specifications subject to change without notice.

LED MODULES
LED DRIVERS
LED DRIVER CASES
LED LAMPS
LED RETROFIT KITS
LED EMERGENCY BATTERY BACK UP
STEP-DOWN TRANSFORMERS
CONTROL OPTIONS

STANDARD LED MODULES

LED
MODULES

LED
DRIVERS

LED
DRIVER CASES

LED
LAMPS

LED
RETROFIT KITS

LED EMERGENCY
BATTERY BACK UP

STEP-DOWN
TRANSFORMERS

CONTROL
OPTIONS

LED Modules - Standard Part Number Break Down

Example part number:

VLM4824L850

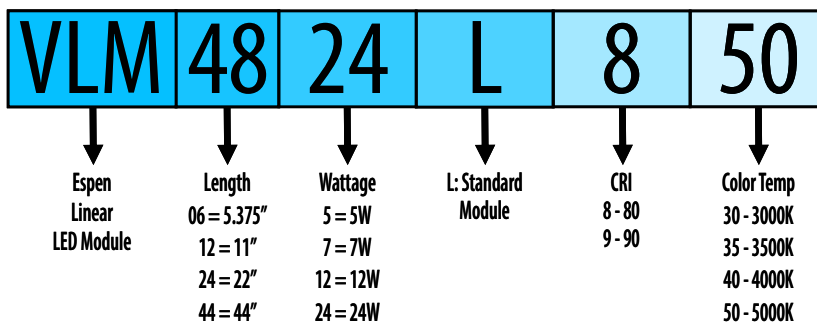

FEATURES AND BENEFITS

- Light output up to 1300 lm/ft
- High efficacy up to 208 lm/W
- Long life min. 50000 hours
- Low profile quick push in connectors
- UL Recognized components
- Class 2

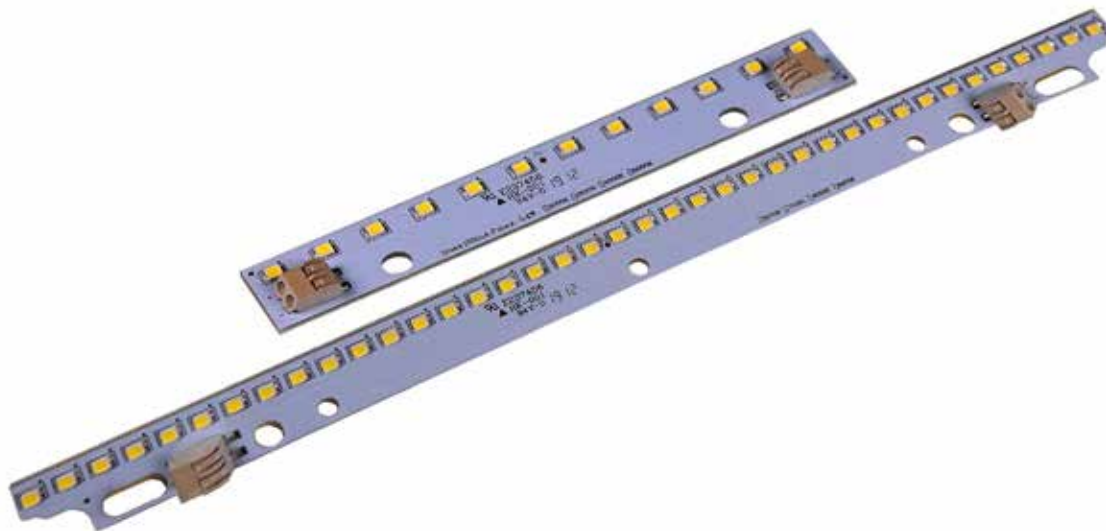

STANDARD LED MODULES

LED
MODULES

LED
DRIVERS

LED
DRIVER CASES

LED
LAMPS

LED
RETROFIT KITS

LED EMERGENCY
BATTERY BACK UP

STEP-DOWN
TRANSFORMERS

CONTROL
OPTIONS

5.375" MODULES

MODEL #	COLOR TEMP	MAX POWER (W)	VF	MAX CURRENT (mA)	MAX LUMENS	CRI	MAX EFFICACY (LPW)
VLM0605L/830	3000K	5	33	150	845	80	169
VLM0605L/835	3500K	5	33	150	845	80	169
VLM0605L/840	4000K	5	33	150	860	80	172
VLM0605L/850	5000K	5	33	150	873	80	174

11" MODULES

MODEL #	COLOR TEMP	MAX POWER (W)	VF	MAX CURRENT (mA)	MAX LUMENS	CRI	MAX EFFICACY (LPW)
VLM1207L/830	3000K	7	34	210	1316	80	188
VLM1207L/835	3500K	7	34	210	1316	80	188
VLM1207L/840	4000K	7	34	210	1340	80	191
VLM1207L/850	5000K	7	34	210	1360	80	194

VLM0605L/8XX

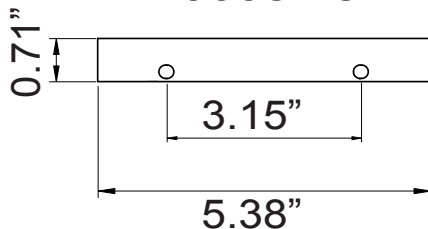

VLM1207L/8XX

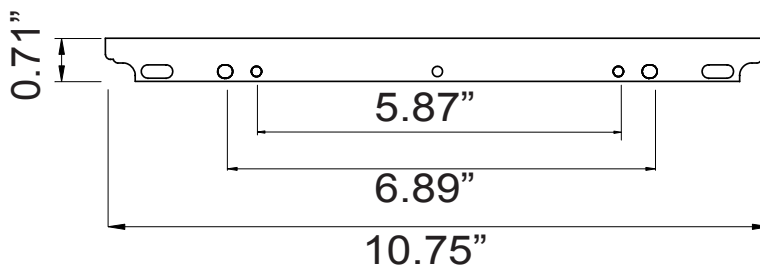

STANDARD LED MODULES

LED
MODULES

22" MODULES

MODEL #	COLOR TEMP	MAX POWER (W)	VF	MAX CURRENT (mA)	MAX LUMENS	CRI	MAX EFFICACY (LPW)
VLM2412L/830	3000K	12	35	350	2419	80	201
VLM2412L/835	3500K	12	35	350	2419	80	201
VLM2412L/840	4000K	12	35	350	2463	80	205
VLM2412L/850	5000K	12	35	350	2500	80	208

LED
DRIVERS

LED
DRIVER CASES

44" MODULES

MODEL #	COLOR TEMP	MAX POWER (W)	VF	MAX CURRENT (mA)	MAX LUMENS	CRI	MAX EFFICACY (LPW)
VLM4824L/830	3000K	24.5	35	700	4616	80	188
VLM4824L/835	3500K	24.5	35	700	4616	80	188
VLM4824L/840	4000K	24.5	35	700	4700	80	192
VLM4824L/850	5000K	24.5	35	700	4770	80	195

LED
LAMPS

VLM2412L/8XX

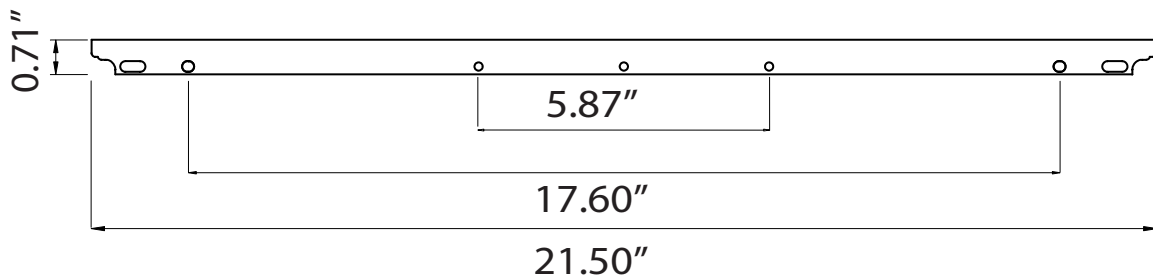

LED
RETROFIT KITS

VLM4824L/8XX

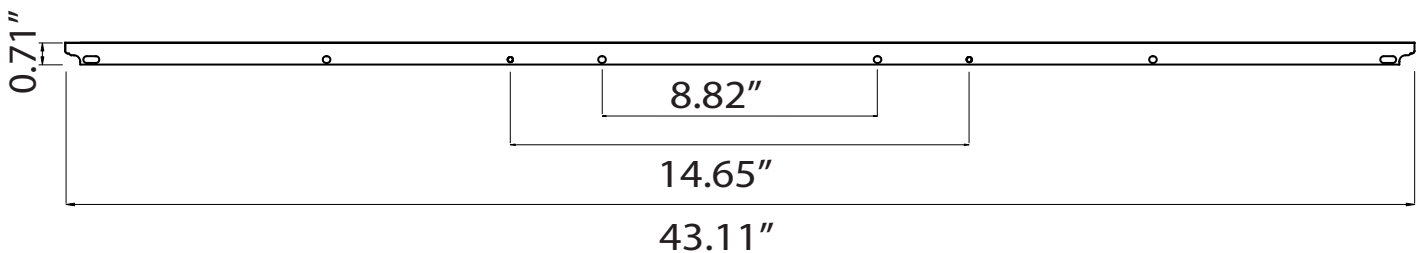

LED EMERGENCY
BATTERY BACK UP

STEP-DOWN
TRANSFORMERS

CONTROL
OPTIONS

LED Drivers - Constant Current Part Number Break Down

Example part number:
VEL30054MVHDA-10V-1

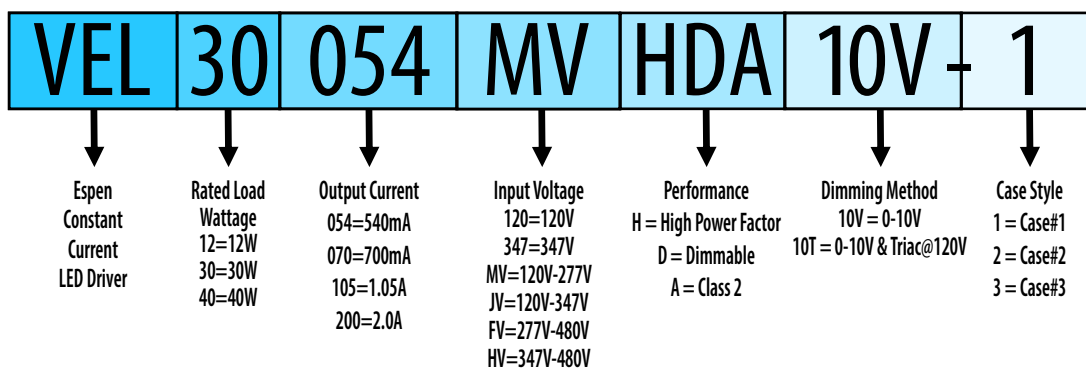

FEATURES AND BENEFITS

- Multiple constant current output configurations
- Wide range of wattages available
- High efficiency
- MV models with active power factor correction
- 100% full load burn in test
- 5 year warranty



LED DRIVERS - CONSTANT CURRENT

CONSTANT CURRENT

MODEL #	MAX POWER	INPUT VOLTAGE	DIMMING	EFFICIENCY AT NOMINAL LOAD	OUTPUT VOLTAGE MAX RANGE	OUTPUT CURRENT RANGE	MIN START TEMP	IP RATING
VEL2700120M-3	6	120	N/A	85	3-8	700	-25	IP20
VEL6XXX120H-3	6	120	N/A	85	3-8	200-700	-25	IP20
VEL6XXX120M-3	6	120	N/A	85	3-8	200-700	-25	IP20
VEL3700120H-1	8	120	N/A	85	8-12	700	-25	IP20
VEL8XXX120H-1	8	120	N/A	85	6-30	200-700	-25	IP20
VEL12XXX120H-1	12	120	N/A	85	40	200-1050	-25	IP20
VEL12XXX120H-2	12	120	N/A	85	40	200-1050	-25	IP20
VEL12XXX120H-3	12	120	N/A	85	40	200-1050	-25	IP20
VEL12XXXMVH-1	12	120-277	N/A	85	40	200-1050	-25	IP20
VEL12XXXMVH-2	12	120-277	N/A	85	40	200-1050	-25	IP20
VEL12XXXMVH-3	12	120-277	N/A	85	40	200-1050	-25	IP20
VEL12XXXMVH-32	12	120-277	N/A	85	6-33	200-1050	-25	Damp
VEL12XXX120HDA-1	12	120	Triac	85	10-34	200-1050	-25	IP20
VEL12XXX120HDA-2	12	120	Triac	85	10-34	200-1050	-25	IP20
VEL12XXX120HDA-3	12	120	Triac	85	10-34	200-1050	-25	IP20
VEL12XXX120HDA-1v1	12	120	Triac	85	50	200-1050	-25	Damp
VEL12XXX120HDA-2v1	12	120	Triac	85	50	200-1050	-25	Damp
VEL12XXX120HDA-3v1	12	120	Triac	85	50	200-1050	-25	Damp
VEL12XXXMVH-51	12	100-277	N/A	80-8	6-48	250-1000	-30	IP66
VRL25XXXMVHDA-10V-P-1	12-2	120-277	0-10V/PWM	5	45	800	-30	Damp
VEL18035MVH-11	5	120-277	N/A	85	33-52	350	-20	IP54
VEL6700120H(10.50) V2 H-4	18	120	N/A	80	18-33	500	-25	IP20
VEL6700120H(10.50) V2 L-4	18	120	N/A	85	13-24	500	-25	IP20
VEL6700120H-4	18	120	N/A	85	15-24	700	-25	IP20
VEL18XXX120H-4	18	120	N/A	85	12-33	200-700	-25	IP20
VEL19XXX120H-1	18	120	N/A	85	40	200-1050	-25	IP20
VEL19XXX120H-2	19	120	N/A	85	40	200-1050	-25	IP20
VEL19XXXMVH-1	19	120-277	N/A	85	10-36	200-1050	-25	Damp
VEL19XXXMVH-2	19	120-277	N/A	85	10-36	200-1050	-25	IP20
VEL19XXXMVH-3	19	120-277	N/A	85	10-36	200-1050	-25	IP20
VEL19XXX120HDA-1	19	120	Triac	85	10-52	200-1200	-25	IP20
VEL19XXX120HDA-2	19	120	Triac	83	10-52	200-1200	-25	IP20
VEL19XXX120HDA-29	19	120	Triac	83	10-52	200-1200	-20	Damp
VEL19XXX120HDA-1v1	19	120	Triac	85	55	200-1500	-25	Damp
VEL19XXX120HDA-2v1	19	120	Triac	85	55	200-1500	-25	Damp
VEL19XXXMVH-29	19	120-277	N/A	85	18-33	350-1050	-25	IP20
VEL19XXX120HDB-1	19	120	Triac	85	15-38	500-1050	-25	IP20
VEL19XXX120HDB-2	19	120	Triac	83	15-38	500-1050	-25	IP20
VEL20070MVH-13	19	120-277	N/A	83	14-29	700	-20	IP54
VEL20XXX120HDA-13	20	120	Triac	80	10-50	400-1050	-25	IP54
VEL12XXXMVHDA-10T	20	120-277	0-10V / Triac @	80	50	200-550	-30	Damp
VEL18XXXMVHDA-10T	24	120-277	120Vac	85	50	200-550	-25	Damp
VEL24XXXMVHDA-10T	24	120-277	Triac	85	21-42	200-550	-25	Damp
VEL25XXX120HDA-1	24	120	Triac	85	10-52	200-1200	-25	IP20
VEL25XXX120HDA-2	25	120	Triac	85	10-52	200-1200	-25	IP20
VEL25XXXMVH-52	25	120-277	Triac	85	6-72	350-2100	-35	IP66
VRL50XXXMVHDA-10V-P-1	25	120/277/24V	N/A	81-8	55	300-1600	-30	Damp
VEL30035MVH-33	26-5	DC	0-10V	8	52-86	350	-35	IP66
VEL30XXXMVH-4	0	90-305	N/A	85	60	1200	-20	IP54
VEL30XXX120H-1	30	120-277	N/A	85	30	1700	-25	IP20
VEL30XXX120H-2	30	120-277	N/A	85	30	1700	-25	IP20
VEL30XXX120H-4	30	120	N/A	85	30	1700	-25	IP20
VEL30XXX120H-42	30	120	N/A	85	30	1700	-25	IP20
VEL30XXXMVH-1	30	120	N/A	83	30	1700	-25	IP20
VEL30XXXMVH-2	30	120-277	N/A	83	30	1700	-25	Damp
VEL30XXXMVHDA-10T	30	120-277	N/A	85	15-32	1000-1400	-25	Damp
VEL30XXXMVH-42	30	120-277	Triac	85	9-30	200-1700	-20	IP54
VEL30XXXMVHDA-10V-1	30	120-277	N/A	85	12-55	200-2500	-30	Damp
VEL30XXXMVHDA-10V-P-1	30	120-277	0-10V	83	12-55	200-2500	-30	Damp
VEL30XXXMVHDA-10V-43	30	120-277	0-10V	83	12-55	200-2500	-25	IP54
VEL29XXXMVH-1	30	120-277	0-10V	83	12-55	200-2500	-25	Damp
VEL30XXXMVH-33	30	120-277	N/A	83	17-43	700-1050	-35	IP66
VEL30XXX120HDA-1	30	90-305	N/A	85	17.7-36	700-1700	-20	IP20
VEL30XXX120HDA-25	30	120	Triac	84	17.7-36	700-1700	-25	IP20

*Please check with factory or individual specification sheets for actual voltage for each current as this number is a maximum range

LED DRIVERS - CONSTANT CURRENT

CONSTANT CURRENT								
UL-P	UL	FCC CLASS	CLASS2	LENGTH (L) IN INCHES	WIDTH (W) IN INCHES	HEIGHT (H) IN INCHES	CASE #	MODEL #
	✓	B	✓	2.54	1.68	1.00	3	VEL2700120M-3
	✓	B	✓	2.54	1.68	1.00	3	VEL6XXX120H-3
	✓	B	✓	2.54	1.68	1.00	3	VEL6XXX120M-3
	✓	B	✓	2.56	1.73	1.10	1	VEL3700120H-1
	✓	B	✓	2.56	1.73	1.10	1	VEL8XXX120H-1
	✓	B	✓	2.56	1.73	1.10	1	VEL12XXX120H-1
	✓	B	✓	R1.38	R1.38	1.38	2	VEL12XXX120H-2
	✓	B	✓	2.54	1.68	1.00	3	VEL12XXX120H-3
	✓	B	✓	2.56	1.73	1.10	1	VEL12XXXMVH-1
	✓	B	✓	R1.38	R1.38	1.38	2	VEL12XXXMVH-2
	✓	B	✓	2.54	1.68	1.00	3	VEL12XXXMVH-3
	✓	B	✓	2.52	R0.73	R0.73	32	VEL12XXXMVH-32
	✓	B	✓	2.56	1.73	1.10	1	VEL12XXX120HDA-1
	✓	B	✓	R1.38	R1.38	1.38	2	VEL12XXX120HDA-2
	✓	B	✓	2.54	1.68	1.00	3	VEL12XXX120HDA-3
	✓	B	✓	2.56	1.73	1.10	1	VEL12XXX120HDA-1v1
	✓	B	✓	R1.38	R1.38	1.38	2	VEL12XXX120HDA-2v1
	✓	B	✓	2.54	1.68	1.00	3	VEL12XXX120HDA-3v1
	✓	B	✓	3.35	1.42	0.91	51	VEL12XXXMVH-51
✓		B	✓	2.56	2.40	1.10	1	VRL25XXXMVHDA-10V-P-1
	✓	B	✓	3.11	2.76	1.02	11	VEL18035MVH-11
	✓	B	✓	2.40	2.40	1.10	4	VEL6700120H(10.50) V2 H-4
	✓	B	✓	2.40	2.40	1.10	4	VEL6700120H(10.50) V2 L-4
	✓	B	✓	2.40	2.40	1.10	4	VEL6700120H-4
	✓	B	✓	2.40	2.40	1.10	4	VEL18XXX120H-4
	✓	B	✓	2.56	1.73	1.10	1	VEL19XXX120H-1
	✓	B	✓	R1.38	R1.38	1.38	2	VEL19XXX120H-2
	✓	B	✓	2.56	1.73	1.10	1	VEL19XXXMVH-1
	✓	B	✓	R1.38	R1.38	1.38	2	VEL19XXXMVH-2
	✓	B	✓	2.54	1.68	1.00	3	VEL19XXXMVH-3
	✓	B	✓	2.56	1.73	1.10	1	VEL19XXX120HDA-1
	✓	B	✓	R1.38	R1.38	1.38	2	VEL19XXX120HDA-2
	✓	B	✓	9.38	0.88	1.00	29	VEL19XXX120HDA-29
✓		B	✓	2.56	1.73	1.10	1	VEL19XXX120HDA-1v1
		B		R1.38	R1.38	1.38	2	VEL19XXX120HDA-2v1
		B		9.38	0.88	1.00	29	VEL19XXXMVH-29
	✓	B	✓	2.56	1.73	1.10	1	VEL19XXX120HDB-1
	✓	B	✓	R1.38	R1.38	1.38	2	VEL19XXX120HDB-2
	✓	B	✓	3.74	1.57	1.00	13	VEL20070MVH-13
	✓	B	✓	3.74	1.57	1.00	13	VEL20XXX120HDA-13
	✓	A	✓	R1.38	R1.38	1.38	2	VEL12XXXMVHDA-10T
		A		R1.38	R1.38	1.38	2	VEL18XXXMVHDA-10T
	✓	A		3.37	1.60	0.97		VEL24XXXMVHDA-10T
	✓	B	✓	2.56	1.73	1.10	1	VEL25XXX120HDA-1
	✓	B	✓	R1.38	R1.38	1.38	2	VEL25XXX120HDA-2
	✓	B	✓	3.15	2.44	1.06	52	VEL25XXXMVH-52
✓		B		9.50	1.70	1.20	1	VRL50XXXMVHDA-10V-P-1
	✓	/		4.45	1.63	1.18	33	VEL30035MVH-33
✓		B	✓	7.20	1.18	0.83	4	VEL30XXXMVH-4
	✓	B	✓	2.56	1.73	1.10	1	VEL30XXX120H-1
	✓	B	✓	R1.38	R1.38	1.38	2	VEL30XXX120H-2
	✓	B	✓	2.40	2.40	1.10	4	VEL30XXX120H-4
	✓	B	✓	8.91	1.30	1.00	42	VEL30XXX120H-42
	✓	B	✓	2.56	1.73	1.10	1	VEL30XXXMVH-1
				R1.38	R1.38	1.38	2	VEL30XXXMVH-2
	✓	A		3.37	1.60	0.97		VEL30XXXMVHDA-10T
	✓	B	✓	8.91	1.30	1.00	42	VEL30XXXMVH-42
	✓	A	✓	4.67	1.25	1.20	1	VEL30XXXMVHDA-10V-1
✓		B	✓	4.67	1.25	1.20	1	VEL30XXXMVHDA-10V-P-1
	✓	B	✓	4.47	1.25	1.18	43	VEL30XXXMVHDA-10V-43
	✓	B	✓	2.56	1.73	1.10	1	VEL29XXXMVH-1
	✓	/	✓	4.45	1.63	1.18	33	VEL30XXXMVH-33
	✓	B		2.56	1.73	1.10	1	VEL30XXX120HDA-1
	✓	B	✓	4.70	1.70	1.20	25	VEL30XXX120HDA-25

*Please check with factory or individual specification sheets for actual voltage for each current as this number is a maximum range

LED
MODULES

LED
DRIVERS

LED
DRIVER CASES

LED
LAMPS

LED
RETROFIT KITS

LED
EMERGENCY
BATTERY BACK UP

STEP-DOWN
TRANSFORMERS

CONTROL
OPTIONS

LED DRIVERS - CONSTANT CURRENT

CONSTANT CURRENT

MODEL #	MAX POWER	INPUT VOLTAGE	DIMMING	EFFICIENCY AT NOMINAL LOAD	OUTPUT VOLTAGE MAX RANGE	OUTPUT CURRENT RANGE	MIN START TEMP	IP RATING
VPL50-2C 030/036	33	120-277	0-10V		20 - 46	300 or 360	-30	Damp
VEL40XXX120H-1	40	120	N/A	85	22.2	2500	-25	IP20
VEL40XXX120H-2	40	120	N/A	85	22.2	2500	-25	IP20
VEL40XXX120H-4	40	120	N/A	83	22.2	2500	-25	IP20
VEL40XXX120H-47	40	120	N/A	83	22.2	2500	-25	IP20
VEL40XXX120HA-1	40	120	N/A	85	55	2500	-25	Damp
VEL40XXX120HA-2	40	120	N/A	85	55	2500	-25	Damp
VEL40XXXMVH-1	40	120-277	N/A	85	22.2	2500	-25	IP20
VEL40XXXMVH-2	40	120-277	N/A	85	22.2	2500	-25	IP20
VEL40XXXMVHA-1	40	120-277	N/A	85	55	2500	-25	Damp
VEL40XXXMVHA-2	40	120-277	N/A	85	55	2500	-25	Damp
VEL40XXXMVHA-4	40	120-277	N/A	85	55	2500	-25	IP20
VEL40XXXMVHA-47	40	120-277	N/A	85	55	2500	-25	IP20
VEL40XXXMVH-4	40	120-277	N/A	85	60	2500	-20	IP20
VEL40XXXMVH-47	40	120-277	N/A	85	60	2500	-20	IP20
VEL40XXXMVHDA-10V-35	40	120-277	0-10V	87	13-36	3080	-20	IP20
VEL40XXXMVHDA-10T	40	120-277	Triac	85	20-56	1000-1400	-20	Damp
VEL40XXX120HDA-1	40	120	Triac	83	16-28	1400-2500	-25	IP20
VEL40XXX120HDA-25	40	120	Triac	83	16-28	1400-2500	-25	IP20
VEL40XXXMVHB-1-53	40	120-277	N/A	83-8	4-114	350-3330	-30	IP66
VPL40-XXX-MVHDA-10V-1	40	120-277	0-10V	7	50	500-1600	-35	IP54
VPL40-XXX-MVHDA-10V-P-1	40	120-277	0-10V	85	50	500-1600	-40	Damp
VEL40XXX120HA-4	40	120	N/A	85	16-55	650-2500	-25	Damp
VEL40XXX120HA-47	40	120	N/A	83	16-55	650-2500	-25	Damp
VEL45XXXMVHDA-10V-4	45	120-278	0-10V	83	50	1200	-25	Damp
VEL45XXXMVH-4	45	120-277	N/A	83	60	1200	-20	Damp
VELP24XXXMVHDA-10V-1	50	120-277	0-10V	85	24	800	-25	Damp
VELP40XXXMVHDA-10V-1	50	120-277	0-10V	85	40	1100	-25	Damp
VELP50XXXMVHDA-10V-1	50	120-277	0-10V	85	50	1200	-25	Damp
VEL50XXXMVH-1	50	120-277	N/A	85	60	1200	-30	IP20
VEL50XXX347HDA-10V-49	50	347	0-10V	85	55	1600	-30	IP20
VEL50XXXJVHDA-10V-27	50	120-347	0-10V	85	55	1600	-30	Damp
VEL50XXXMVHDA-10V-35	50	120-277	0-10V	85	15-36	3330	-20	IP20
VEL50XXXMVHDA-10T	50	120-277	Triac	87	21-43	1000-1400	-25	Damp
VEL50XXXJVHDA-10V-1	50	120-347	0-10V	85	48	1000-1600	-30	Damp
VEL50XXX/ZZ347HDA-10V-1	50	347	0-10V	85	55	300-1800	-30	Damp
VEL50XXX347HDA-10V-27	50	347	0-10V	85	55	300-1800	-30	IP20
VEL50XXX347HDA-10V-45	50	347	0-10V	85	55	300-1800	-30	Damp
VEL50XXXHVHDA-10V-27	50	347-480	0-10V	85	55	300-1800	-30	Damp
VEL50XXXHVHDA-10V-45	50	347-480	0-10V	85	55	300-1800	-30	Damp
VPL50-XXX-MVHDA-PD-2C-27	50	120-277	0-10V	85	20-50	300-600	-25	IP20
VEL50XXXMVHDB-10V-54	50	120-277	0-10V	85	8-142	350-3150	-30	IP27
VEL50XXXMVHB-54	50	120-277	N/A	84-9	8-142	350-3150	-35	IP67
VPL50-XXX-MVHDA-10V-1	50	120-277	0-10V	0	50	500-1600	-35	IP54
VPL50-XXX-MVHDA-10V-P-1	50	120-277	0-10V	84-9	50	500-1600	-35	IP54
VPL50-XXX-MVHDA-PD-1C-27	50	120-277	0-10V	0	28-55	540-1150	-20	Damp
VEL50XXXMVHDA-10V-80	50	120-277	0-10V	85	21-42	600-1200	-30	Damp
VPL50-XXX-27	50	120-277	0-10V	85	28-55	600-1200	-30	IP20
VEL50XXXMVH-47	50	120-277	N/A	85	28-55	600-1200	-30	Damp
VEL60XXXMVHDA-10V-1	60	120-277	0-10V	85	20-36	3000	-20	Damp
VEL60XXXMVHDA-10V-35	60	120-277	0-10V	85	20-36	3000	-20	IP20
VEL60XXXMVHDA-10V-P-1	60	120-277	0-10V	85	50	1000-2800	-30	Damp
VEL60XXXMVHDB-10V-55	60	120-277	0-10V	87	6-170	350-5000	-35	IP67
VEL60XXXMVHB-55	60	120-277	N/A	87	6-170	350-5000	-30	IP67
VPL60XXXMVHDB-10V-T-55	60	120-277	Time Shared/0-10V/PWM	87	6-170	350-5000	-40	IP67
VPL60-XXX-MVHDA-10V-27	60	120-277	0-10V	83-8	55	300-1600	-25	Damp
VEL75XXXMVHDA-10V-1	75	120-277	0-10V	8	50	3120	-30	Damp
VEL75XXXMVHDA-10V-35	75	120-277	0-10V	83-8	24-36	3120	-20	IP20
VEL75XXXMVHDA-10V-P-1	75	120-277	0-10V	8	50	1000-2800	-30	Damp
VEL96XXXMVH-57	75	120-277	N/A	83-8	12-55	1750-4200	-30	IP67
VEL75XXXMVHDB-10V-55	75	120-277	0-10V	8	7-214	350-5000	-35	IP67
VEL75XXXMVHB-55	75	120-277	N/A	85	7-214	350-5000	-30	IP67
VPL75XXXMVHDB-10V-T-55	75	120-277	Time Shared/0-10V/PWM	87	7-214	350-5000	-40	IP67
VEL80XXXMVHDA-10V-P-1	80	120-277	0-10V	87	50	1000-2800	-25	Damp

*Please check with factory or individual specification sheets for actual voltage for each current as this number is a maximum range

LED MODULES
LED DRIVERS
LED DRIVER CASES
LED LAMPS
LED RETROFIT KITS
LED EMERGENCY BATTERY BACKUP
STEP-DOWN TRANSFORMERS
CONTROL OPTIONS

LED DRIVERS - CONSTANT CURRENT

CONSTANT CURRENT								
UL-P	UL	FCC CLASS	CLASS2	LENGTH (L) IN INCHES	WIDTH (W) IN INCHES	HEIGHT (H) IN INCHES	CASE #	MODEL #
✓		B	✓	9.50	1.30	1.00	27	VPL50-2C 030/036
	✓	B	✓	2.56	1.73	1.10	1	VEL40XXX120H-1
	✓	B	✓	R1.38	R1.38	1.38	2	VEL40XXX120H-2
	✓	B	✓	7.20	1.18	0.83	4	VEL40XXX120H-4
	✓	B	✓	8.91	1.30	1.22	47	VEL40XXX120H-47
	✓	B	✓	2.56	1.73	1.10	1	VEL40XXX120HA-1
	✓	B	✓	R1.38	R1.38	1.38	2	VEL40XXX120HA-2
	✓	B	✓	2.56	1.73	1.10	1	VEL40XXXMVH-1
	✓	B	✓	R1.38	R1.38	1.38	2	VEL40XXXMVH-2
	✓	B	✓	2.56	1.73	1.10	1	VEL40XXXMVHA-1
	✓	B	✓	R1.38	R1.38	1.38	2	VEL40XXXMVHA-2
	✓	B	✓	7.20	1.18	0.83	4	VEL40XXXMVHA-4
	✓	B	✓	8.91	1.30	1.22	47	VEL40XXXMVHA-47
	✓	B	✓	7.20	1.18	0.83	4	VEL40XXXMVH-4
	✓	B	✓	8.91	1.30	1.22	47	VEL40XXXMVH-47
	✓	B	✓	8.91	1.70	1.20	35	VEL40XXXMVHDA-10V-35
	✓	B	✓	5.06	2.37	1.02		VEL40XXXMVHDA-10T
	✓	B	✓	2.56	1.73	1.10	1	VEL40XXX120HDA-1
	✓	B	✓	4.70	1.70	1.20	25	VEL40XXX120HDA-25
	✓	B	✓	3.74	2.76	1.26	53	VEL40XXXMVHB-1-53
	✓	B	✓	9.50	1.30	1.00	1	VPL40-XXX-MVHDA-10V-1
✓		B	✓	9.50	1.30	1.00	1	VPL40-XXX-MVHDA-10V-P-1
	✓	B	✓	7.20	1.18	0.83	4	VEL40XXX120HA-4
	✓	B	✓	8.91	1.30	1.22	47	VEL40XXX120HA-47
				7.20	1.18	0.83	4	VEL45XXXMVHDA-10V-4
	✓	B	✓	7.20	1.18	0.83	4	VEL45XXXMVH-4
✓		B		8.30	3.40	1.26	1	VELP24XXXMVHDA-10V-1
✓		B		8.30	3.40	1.26	1	VELP40XXXMVHDA-10V-1
✓		B	✓	8.30	3.40	1.26	1	VELP50XXXMVHDA-10V-1
	✓	B	✓	9.50	1.30	1.00	1	VEL50XXXMVH-1
	✓	A	✓	10.65	1.16	1.00	49	VEL50XXX347HDA-10V-49
	✓	B	✓	8.91	1.30	1.00	27	VEL50XXXJVHDA-10V-27
	✓	B	✓	8.91	1.70	1.20	35	VEL50XXXMVHDA-10V-35
		A		5.06	2.37	1.02		VEL50XXXMVHDA-10T
	✓	A	✓	9.50	1.30	1.00	1	VEL50XXXJVHDA-10V-1
	✓	A	✓	11.03	1.16	1.00	1	VEL50XXX/ZZZ347HDA-10V-1
	✓	A	✓	9.50	1.30	1.00	27	VEL50XXX347HDA-10V-27
	✓	A	✓	6.00	1.78	1.08	45	VEL50XXX347HDA-10V-45
	✓	A	✓	9.50	1.30	1.00	27	VEL50XXXHVHDA-10V-27
	✓	A	✓	6.00	1.78	1.08	45	VEL50XXXHVHDA-10V-45
	✓	A	✓	8.91	1.30	1.00	27	VPL50-XXX-MVHDA-PD-2C-27
	✓	A	✓	6.77	1.67	1.34	54	VEL50XXXMVHDB-10V-54
	✓	B		6.77	1.67	1.34	54	VEL50XXXMVHB-54
	✓	B	✓	9.50	1.30	1.00	1	VPL50-XXX-MVHDA-10V-1
✓		B	✓	9.50	1.30	1.00	1	VPL50-XXX-MVHDA-10V-P-1
	✓	B	✓	8.91	1.30	1.00	27	VPL50-XXX-MVHDA-PD-1C-27
	✓	B		6.05	1.81	1.07	80	VEL50XXXMVHDA-10V-80
✓		B	✓	8.91	1.30	1.00	27	VPL50-XXX-27
	✓	B		8.91	1.30	1.22	47	VEL50XXXMVH-47
	✓	B	✓	9.50	1.70	1.20	1	VEL60XXXMVHDA-10V-1
	✓	/		8.91	1.70	1.20	35	VEL60XXXMVHDA-10V-35
✓		B	✓	9.50	1.70	1.20	1	VEL60XXXMVHDA-10V-P-1
	✓	B		5.94	2.66	1.46	57	VEL60XXXMVHDB-10V-55
	✓	B	✓	5.94	2.66	1.46	55	VEL60XXXMVHB-55
	✓	/		5.94	2.66	1.46	55	VPL60XXXMVHDB-10V-T-55
				9.50	1..3	1.00	51	VPL60-XXX-MVHDA-10V-27
	✓	B	✓	9.50	1.70	1.20	1	VEL75XXXMVHDA-10V-1
	✓	B	✓	8.91	1.70	1.20	35	VEL75XXXMVHDA-10V-35
✓		B	✓	9.50	1.70	1.20	1	VEL75XXXMVHDA-10V-P-1
	✓	B	✓	6.89	2.66	1.46	57	VEL96XXXMVH-57
	✓	B		5.94	2.66	1.46	55	VEL75XXXMVHDB-10V-55
	✓	B	✓	5.94	2.66	1.46	55	VEL75XXXMVHB-55
	✓	/		5.94	2.66	1.46	55	VPL75XXXMVHDB-10V-T-55
✓		B		9.50	1.70	1.20	1	VEL80XXXMVHDA-10V-P-1

*Please check with factory or individual specification sheets for actual voltage for each current as this number is a maximum range

*Pend. = Pending

LED
MODULES

LED
DRIVERS

LED
DRIVER CASES

LED
LAMPS

LED
RETROFIT KITS

LED
EMERGENCY
BATTERY BACK UP

STEP-DOWN
TRANSFORMERS

CONTROL
OPTIONS

LED DRIVERS - CONSTANT CURRENT

CONSTANT CURRENT								
MODEL #	MAX POWER	INPUT VOLTAGE	DIMMING	EFFICIENCY AT NOMINAL LOAD	OUTPUT VOLTAGE MAX RANGE	OUTPUT CURRENT RANGE	MIN START TEMP	IP RATING
VEL80XXXHVHDA-10V-35	80	347-480	0-10V	85	55	300-1800	-30	Damp
VEL96XXXMVHDA-10V-57	96	120-277	0-10V	87-89	12-55	1750-4200	-35	IP67
VEL100XXX347HDA-10V-50	100	347	0-10V	87	55	4200	-30	IP20
VEL100XXXJVHDA-10V-50	100	120-347	0-10V	87	55	4200	-30	IP20
VEL100XXXHVHDA-10V-50	100	347-480	0-10V	87	55	4200	-30	IP20
VEL100XXXJVHDA-10V-P-35	100	120-347	0-10V	87	50	1000-2500	-25	Damp
VEL100XXX347HDA-10V-P-35	100	347	0-10V	87	50	1000-2500	-25	Damp
VEL100XXXMVHDA-10V-P-1	100	120-277	0-10V	87	50	1000-2800	-30	Damp
VEL100XXXJVHDA-10V-1	100	120-347	0-10V	87	48	2000-2700	-30	Damp
VEL100XXXMVHDB-10V-58	100	120-277	0-10V	88-90	12-286	350-4200	-35	IP67
VEL100XXXMVHB-58	100	120-277	N/A	88-90	12-286	350-4200	-30	IP67
VPL100-XXX-MVHDA-PD-4C-35	100	120-277	0-10V	87	20-52	400-700	-20	IP20
VPL100-XXX	100	120/277	0-10V	87	50	680-2720	-30	IP20
VPL100-XXX-35	100	120-277	0-10V	87	35-45	680-2720	-25	IP20
VEL100XXXHVHDA-10V-1	100	347-480	0-10V	85	56	800-4200	-30	Damp
VEL120XXXMVHDB-10V-58	120	120-277	0-10V	87-90	12-343	350-5000	-35	IP67
VEL120XXXMVHB-58	120	120-277	N/A	88-90	12-343	350-5000	-30	IP67
VPL120XXXMVHDB-10V-T-58	120	120-277	Time Shared/0-10V/PWM	87-90	12-343	350-5000	-40	IP67
VEL150XXXMVHDB-10V-62	150	120-277	0-10V	88-90	15-428	350-5000	-35	IP67
VEL150XXXMVHB-62	150	120-277	N/A	88-90	15-428	350-5000	-30	IP67
VEL200XXXMVHDB-10V-63	200	120-277	0-10V	88-90	17-571	350-6000	-35	IP67
VEL200XXXMVHB-63	200	120-277	N/A	88-90	17-571	350-6000	-30	IP67
VPL200XXXMVHDB-10V-T-63	200	120-277	Time Shared/0-10V/PWM	88-90	17-571	350-6000	-40	IP67
VPL600XXXMVHDA-YY	600	100/277	0-10V/PWM	95	24/30/36/42/48/54	25000	-25	IP67
VPL1200XXXMVHDA-YY	1200	100/277	0-10V/PWM	94	24/30/36/42/48/54	50000	-25	IP67

*Please check with factory or individual specification sheets for actual voltage for each current as this number is a maximum range

LED DRIVERS - CONSTANT CURRENT

CONSTANT CURRENT								
UL-P	UL	FCC CLASS	CLASS2	LENGTH (L) IN INCHES	WIDTH (W) IN INCHES	HEIGHT (H) IN INCHES	CASE #	MODEL #
	✓	A	✓	9.50	1.70	1.20	35	VEL80XXXHVHDA-10V-35
	✓	B		6.89	2.66	1.46	57	VEL96XXXMVHDA-10V-57
	✓	A	✓	8.89	2.36	1.65	50	VEL100XXX347HDA-10V-50
	✓	A	✓	8.89	2.36	1.65	50	VEL100XXXJVHDA-10V-50
	✓	A	✓	8.89	2.36	1.65	50	VEL100XXXHVHDA-10V-50
✓				9.50	1.70	1.20	35	VEL100XXXJVHDA-10V-P-35
✓				9.50	1.70	1.20	35	VEL100XXX347HDA-10V-P-35
✓		B	✓	9.50	1.70	1.20	1	VEL100XXXMVHDA-10V-P-1
	✓	A	✓	9.50	1.70	1.20	1	VEL100XXXJVHDA-10V-1
	✓	B		7.64	2.66	1.46	58	VEL100XXXMVHDB-10V-58
	✓	B	✓	7.64	2.66	1.46	58	VEL100XXXMVHB-58
	✓	B	✓	8.91	1.70	1.20	35	VPL100-XXX-MVHDA-PD-4C-35
✓		B	✓	9.50	1.70	1.20	35	VPL100-XXX
	✓	B	✓	9.50	1.70	1.20	35	VPL100-XXX-35
	✓	A	✓	9.50	2.36	1.66	1	VEL100XXXHVHDA-10V-1
	✓	B		7.64	2.66	1.46	58	VEL120XXXMVHDB-10V-58
	✓	B	✓	7.64	2.66	1.46	58	VEL120XXXMVHB-58
	✓	B		7.64	2.66	1.46	58	VPL120XXXMVHDB-10V-T-58
	✓	B		7.83	2.66	1.57	62	VEL150XXXMVHDB-10V-62
	✓	B	✓	7.83	2.66	1.57	62	VEL150XXXMVHB-62
	✓	B	✓	8.82	2.66	1.57	63	VEL200XXXMVHDB-10V-63
	✓	B	✓	8.82	2.66	1.57	63	VEL200XXXMVHB-63
	✓	B		8.82	2.66	1.57	63	VPL200XXXMVHDB-10V-T-63
		A		11.06	5.70	2.00		VPL600XXXMVHDA-YY
		A		11.70	8.50	3.10		VPL1200XXXMVHDA-YY

LED
MODULES

LED
DRIVERS

LED
DRIVER CASES

LED
LAMPS

LED
RETROFIT KITS

LED EMERGENCY
BATTERY BACK UP

STEP-DOWN
TRANSFORMERS

CONTROL
OPTIONS



intelliLUX™ controllability.

LED Drivers - Selectable Current Part Number Break Down

Example part number:

VRL50075MVHDA-MD-P-CCT-JE 054/067/075

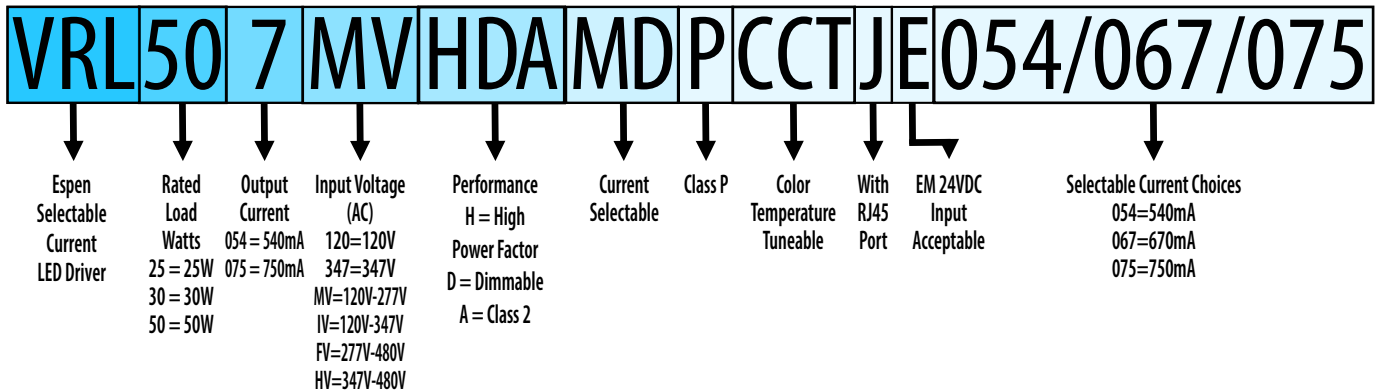

FEATURES AND BENEFITS

- Selectable current
- Selectable CCT
- Factory program models available
- Inteliport available for control systems
- Multiple case designs
- Multiple channels



intelliLUX™ SELECTABLE CURRENT & CCT

SELECTABLE CURRENT							
MODEL #	RATED POWER (W)	Vin	DIMMING	EFFICIENCY AT NOMINAL LOAD	OUTPUT VOLTAGE MAX RANGE	OUTPUT CURRENT RANGE	OUTPUT CURRENT OPTIONS
VEL24XXXMVHDA-10T-MD	24	120-277	Triac	85	21-42	200-550	none
VRL50042347MDA-MD-1	26	347	PWM / 0 - 10V	85	24 ~ 48	540	Factory Set (RJ45)
VRL50XXXMVHDA-MD-P-1	26-50	120-277/24V DC	0-10V	85	55	300-1600	none
VRL30070MVHDA-MD-P-1	30	120 - 277	0 - 10V / Dim to Off	85	24 ~ 48	400/500/700	Selectable Current (Toggle Switch)
VRL30100MVHDA-MD-P-1	30	120 - 277	0 - 10V / Dim to Off	85	24 ~ 48	700/850/1000	Selectable Current (Toggle Switch)
VEL30XXXMVHDA-10T-MD	30	120-277	Triac	85	15-32	1000-1400	none
VPL30-XXXMVHDA-10V-P-CCT	30	120-277	0-10V	85	55	200-1000	none
VRL50054347MDA-MD-P-1	32	347	PWM / 0 - 10V	85	24 ~ 48	650	Factory Set (RJ45)
VRL50065347MDA-MD-P-1	36	347	PWM / 0 - 10V	85	24 ~ 48	750	Factory Set (RJ45)
VPL40-XXX-MVHDA-10V-P-CCT	40	120-277	0-10V	85	55	200-1000	none
VRL50075347MDA-MD-P-1	41	347	PWM / 0 - 10V	85	24 ~ 48	850	Factory Set (RJ45)
VRL50085347MDA-MD-P-1	50	347	0 - 10V / Dim to Off	85	24 ~ 41	1200	Factory Set (RJ45)
VPL50120MVHDA-MD-78	50	120 - 277	PWM / 0 - 10V	85	26 ~ 40	1200	none
VRL50100347HDA-10V-1	50	347	0 - 10V / Dim to Off	85	20 ~ 36	1400	Factory Set (RJ45)
VPL50140MVHDA-MD-78	50	120 - 277	PWM / 0 - 10V	85	26 ~ 35	1400	none
VPL50-140-MVHDA-MD-P-1	50	120 - 277	0 - 10V	85	26 ~ 50 26 ~ 40 26 ~ 42 26 ~ 35"	1000 1150 1200 1400	Selectable Current (Dip Switch)
VELP24XXXMVHDA-MD-1	50	120-277	0-10V	85	24	800	none
VELP40XXXMVHDA-MD-1	50	120-277	0-10V	85	40	1100	none
VELP50XXXMVHDA-MD-1	50	120-277	0-10V	85	50	1200	none
VPL50-XXX-MVHDA-MD-P-1	50	120-277	0-10V	85	50	500-1600	none
VPL50XXX-MVHDA-PD-2C	50	120-277	0~10V / Dual Relay	85	25 - 50	300-600	Factory Set
VEL50XXXMVHDA-MD-80	50	120-277	0-10V	85	21-42	600-1200	none
VPL50-XXX-MVHDA-10V-P-CCT	50	120-277	0-10V	85	55	200-1200	none
VPL60-XXX-MVHDA-10V-P-CCT	60	120-277	0-10V	85	55	200-1760	none
VPL60-XXX-MVHDA-MD-27	60	120-277	0-10V	85	55	300-1600	none
VPL100MVHUD-A-4C-XXX	80	120-277	0~10V / Dual Relay	87	25 - 50	200 - 500	Factory Set
VRL100240347HDA-10V-1	98	347	0 - 10V / Dim to Off	85	35 ~ 48	2400	Factory Set (RJ45)
VEL100XXXMVHDA-MD-P-35	100	120-277	0-10V	87	50	1000-2500	none
VEL100XXXJVHDA-MD-P-35	100	120/347	0-10V	87	50	1000-2500	none
VEL100XXX347HDA-MD-P-35	100	347	0-10V	87	50	1000-2500	none

SELECTABLE CURRENT

MIN START TEMP	# OF CHANNELS	IP RATING	UL-P	UL	FCC CLASS	CLASS2	LENGTH (L) IN INCHES	WIDTH (W) IN INCHES	HEIGHT (H) IN INCHES	MODEL #
-25		Damp		✓	A		3.37	1.60	0.97	VEL24XXXMVHDA-10T-MD
-30	1	IP20	✓		B	✓	9.50	1.70	1.20	VRL50042347MDA-MD-1
-30	9.5x1.7x1.2 (RJ45, AUX PWR., Output Selectable)	Damp	✓		B	✓	9.50	1.70	1.20	VRL50XXXMVHDA-MD-P-1
-30	1	IP20	✓		B	✓	6.00	1.80	1.10	VRL30070MVHDA-MD-P-1
-30	1	IP20	✓		B	✓	6.00	1.80	1.10	VRL30100MVHDA-MD-P-1
-25		Damp			A		3.37	1.60	0.97	VEL30XXXMVHDA-10T-MD
-25	9.5x1.3x1	Damp	✓		B		9.50	1.30	1.00	VPL30-XXXMVHDA-10V-P-CCT
-30	1	IP20	✓		B	✓	9.50	1.70	1.20	VRL50054347MDA-MD-P-1
-30	1	IP20	✓		B	✓	9.50	1.70	1.20	VRL50065347MDA-MD-P-1
-25		Damp	✓		B		9.50	1.30	1.00	VPL40-XXX-MVHDA-10V-P-CCT
-30	1	IP20	✓		B	✓	9.50	1.70	1.20	VRL50075347MDA-MD-P-1
-30	1	IP20	✓		B	✓	9.50	1.70	1.20	VRL50085347MDA-MD-P-1
-30	2	IP20	✓		B	✓	9.50	1.70	1.20	VPL50120MVHDA-MD-78
-30	1	IP20	✓		B	✓	9.50	1.70	1.20	VRL50100347HDA-10V-1
-30	2	IP20	✓		B	✓	9.50	1.70	1.20	VPL50140MVHDA-MD-78
-30	1	IP20	✓		B	✓	9.50	1.30	1.03	VPL50-140-MVHDA-MD-P-1
-25	8.3x3.4x1.26 (Output Selectable)	Damp	✓		B		8.30	3.40	1.26	VELP24XXXMVHDA-MD-1
-25		Damp	✓		B		8.30	3.40	1.26	VELP40XXXMVHDA-MD-1
-25		Damp	✓		B		8.30	3.40	1.26	VELP50XXXMVHDA-MD-1
-25		Damp			B		9.50	1.30	1.00	VPL50-XXX-MVHDA-MD-P-1
-25	2	IP20		✓	B	✓	9.50	1.30	1.00	VPL50XXX-MVHDA-PD-2C
-25		Damp			B		6.05	1.81	1.07	VEL50XXXMVHDA-MD-80
-25		Damp	✓		B		9.50	1.30	1.00	VPL50-XXX-MVHDA-10V-P-CCT
-25		Damp	✓		B		9.50	1.30	1.00	VPL60-XXX-MVHDA-10V-P-CCT
-25		Damp					9.50	1.3	1.00	VPL60-XXX-MVHDA-MD-27
-30	4	Damp	✓		B	✓	9.50	1.70	1.20	VPL100MVHUD-A-4C-XXX
-30	1	IP20	✓		B	✓				VRL100240347HDA-10V-1
-25		Damp					9.50	1.70	1.20	VEL100XXXMVHDA-MD-P-35
-25		Damp					9.50	1.70	1.20	VEL100XXXJVHDA-MD-P-35
-25		Damp					9.50	1.70	1.20	VEL100XXX347HDA-MD-P-35

LED MODULES

LED DRIVERS

LED DRIVER CASES

LED LAMPS

LED RETROFIT KITS

LED EMERGENCY BATTERY BACK UP

STEP-DOWN TRANSFORMERS

CONTROL OPTIONS



LED Drivers - Constant Power Part Number Break Down

Example part number:
VPP50135FVHDA10V-T-76

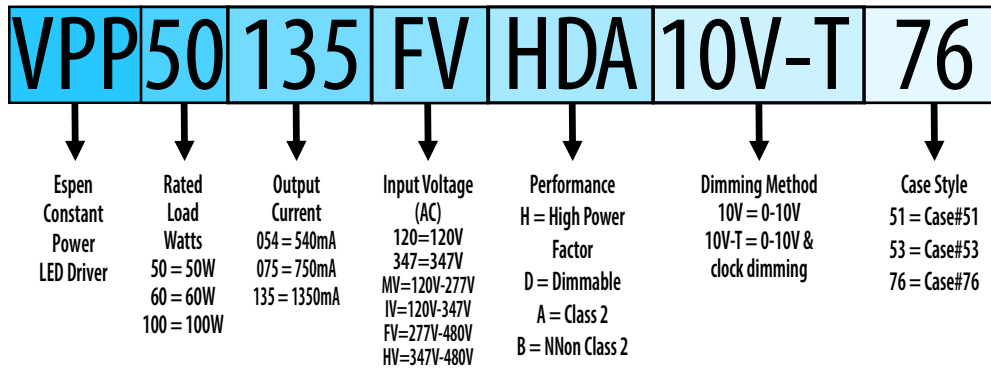

FEATURES AND BENEFITS

- Constant power design
- 0-10V/PWM & time-shared dimming available
- Waterproof case
- High efficiency
- Multiple output current configurations
- Active power factor correction
- 100% full load burn-in test
- 5 year warranty



LED DRIVERS - CONSTANT POWER

LED MODULES
LED DRIVERS
LED DRIVER CASES
LED LAMPS
LED RETROFIT KITS
LED EMERGENCY BATTERY BACKUP
STEP-DOWN TRANSFORMERS
CONTROL OPTIONS

CONSTANT POWER									
MODEL #	MAX POWER (W)	PROGRAM OPTIONS	V _{in}	DIMMING	EFFICIENCY AT NOMINAL LOAD	OUTPUT VOLTAGE MAX RANGE	OUTPUT CURRENT RANGE	MIN START TEMP	IP RATING
VPP42xxxMVHDB-10V-Y	42	Factory	120-277	1~10V/PWM	86	24-140	1100-1400	-25	IP67
VPP50xxFVHDB-10V-T/C-76	50	Factory	277/480	0-10V/PWM/CLCK DIMMING	85	29-143	350-2800	-40	IP67
VPP60xxxMVHDB-10V-T-YY	60	Factory	120-277	0-10V/PWM/dim off	88	24-54	1000-1900	-25	IP65
VPP60xxxFVHDB-10V-T-YY	60	Factory	277/480	1~10V/PWM/CLCK DIMMING	86	18-90	100-2100	-25	IP67
VPP60xxxMVHDB-10V-Y	60	Factory	120-277	1~10V/PWM	87	24-180	140-1800	-25	IP67
VPP75xxxMVHDB-10V-T-AUX	75	Factory	120-277	0-10V/PWM/CLCK DIMMING/dim off/Dali (option)	87	20-141	110-2680	-25	IP67
VPP75xxxMVHDB-10V-Y	75	Factory	120-277	1~10V/PWM	87	20-270	50-2400	-25	IP67
VPL100MVHUD-A-4C-XXX	80	Factory	120-277	0~10V / Dual Relay	87	25 - 50	200 - 500	-30	Damp
VPP100xxFVHDB-10V-T-66	100	Factory	277/480	0-10V/PWM/CLCK DIMMING	85	13-189	530-4800	-40	IP67
VPP100xxxFVHDB-10V-T-68	100	Factory	277-480V	Time Shared/0-10V/PWM	86-89	21-189	530-4800	-40	IP67
VPP100xxxMVHDB-10V-T-66	100	Factory	120-277	Time Shared/0-10V/PWM	85-89	21-189	530-4800	-40	IP67
VPP105xxxFVHDB-10V-T-YY	105	Factory	277/480	1~10V/PWM/CLCK DIMMING	91	18-150	140-4200	-25	IP67
VPP105xxxMVHDB-10V-Y	105	Factory	120-277	1~10V/PWM	90	20-305	100-3300	-25	IP67
VPP120xxxMVHDB-10V-T-AUX	120	Factory	120-277	0-10V/PWM/CLCK DIMMING/dim off/Dali (option)(option)	92	20-305	70-4290	-25	IP67
VPP120xxxMVHDB-10V-T-YY	120	Factory	120-277	0-10V/PWM/dim off	89	20-68	1200-3750	-25	IP65
VPP150xxxMVHDB-10V-T-AUX	150	Factory	120-277	0-10V/PWM/CLCK DIMMING/dim off/Dali (option)	90	20-335	70-5360	-25	IP67
VPP150xxFVHDB-10V-T-67	150	Factory	277/480	0-10V/PWM/CLCK DIMMING	85	15-283	530-6000	-40	IP67
VPP150xxxFVHDB-10V-T-YY	150	Factory	277/480	1~10V/PWM/CLCK DIMMING	91	18-214	110-5000	-40	IP66
VPP150xxxMVHDB-10V-Y	150	Factory	120-277	1~10V/PWM	90	20-335	70-490	-40	IP67
VPP160xxxMVHDB-10V-T-YY	160	Factory	120-277	0-10V/PWM/dim off	88	24-68	1700-5000	-25	IP65
VPP200xxxMVHDB-10V-T-AUX	200	Factory	120-277	0-10V/PWM/CLCK DIMMING/dim off/Dali (option)	90	20-445	70-7000	-25	IP67
VPP200xxxMVHDB-10V-YY	200	Factory	120-277	0-10V/PWM/dim off	88	24-68	2000-6250	-25	IP65
VPP200xxxFVHDB-10V-T-YY	200	Factory	277/480	1~10V/PWM/CLCK DIMMING	91	18-305	100-6600	-25	IP67
VPP200xxxMVHDB-10V-Y	200	Factory	120-277	1~10V/PWM	91	20-445	70-6300	-25	IP67
VPP240xxxMVHDB-10V-T-AUX	240	Factory	120-277	0-10V/PWM/CLCK DIMMING/dim off/Dali (option)	91	20-368	110-7500	-25	IP67
VPP240xxxMVHDB-10V-YY	240	Factory	120-277	0-10V/PWM/dim off	88	24-68	2000-7500	-25	IP65
VPP240xxFVHDB-10V-T-Y	240	Factory	277/480	0-10V/PWM/CLCK DIMMING	92	120-342	70-1050	-40	IP67
VPP240xxxMVHDB-10V-T-63	240	Factory	120-277	Time Shared/0-10V/PWM	93	20-453	530-12000	-40	IP67
VPP240xxxMVHDB-10V-Y	240	Factory	120-277	1~10V/PWM	92	20-368	110-7500	-25	IP67
VPP320xxFVHDB-10V-T-Y	320	Factory	277/480	0-10V/PWM/CLCK DIMMING	93	183-457	70-1050	-25	IP67
VPP320xxxMVHDB-10V-Y	320	Factory	120-277	1~10V/PWM	93	20-457	110-13500	-40	IP67

LED DRIVERS - CONSTANT POWER

CONSTANT POWER							
UL-P	UL	FCC CLASS	CLASS2	LENGTH (L) IN INCHES	WIDTH (W) IN INCHES	HEIGHT (H) IN INCHES	MODEL #
✓		A		6.65	2.50	1.54	VPP42xxxMVHDB-10V-Y
	✓	A	✓	4.00	3.15	1.70	VPP50xxFVHDB-10V-T/C-76
✓		A					VPP60xxxMVHDB-10V-YY
	✓	A		8.15	2.70	1.54	VPP60xxxFVHDB-10V-T-YY
✓		A		6.65	2.50	1.54	VPP60xxxMVHDB-10V-Y
	✓	A		7.00	2.68	1.70	VPP75xxxMVHDB-10V-T-AUX
✓		A		6.46	2.68	1.54	VPP75xxxMVHDB-10V-Y
✓	✓	B	✓	9.50	1.70	1.20	VPL100MVHUD-A-4C-XXX
	✓	A	✓	8.70	2.70	1.40	VPP100xxFVHDB-10V-T-66
	✓	A		7.64	2.66	1.46	VPP100xxxFVHDB-10V-T-68
	✓	/		6.18	2.66	1.46	VPP100xxxMVHDB-10V-T-66
	✓	A		8.90	2.70	1.70	VPP105xxxFVHDB-10V-T-YY
✓		A		7.00	2.68	1.54	VPP105xxxMVHDB-10V-Y
	✓	A		8.50	2.68	1.70	VPP120xxxMVHDB-10V-T-AUX
							VPP120xxxMVHDB-10V-YY
	✓	A		8.50	2.68	1.70	VPP150xxxMVHDB-10V-T-AUX
	✓	A		9.50	1.30	1.00	VPP150xxFVHDB-10V-T-67
✓	✓	A		9.70	2.70	1.70	VPP150xxxFVHDB-10V-T-YY
✓	✓	A		8.15	2.68	1.54	VPP150xxxMVHDB-10V-Y
✓		A					VPP160xxxMVHDB-10V-YY
	✓	A		9.72	2.68	1.70	VPP200xxxMVHDB-10V-T-AUX
✓		A					VPP200xxxMVHDB-10V-YY
	✓	A		10.00	2.70	1.70	VPP200xxxFVHDB-10V-T-YY
✓		A		8.15	3.15	1.57	VPP200xxxMVHDB-10V-Y
	✓	A		9.72	2.68	1.70	VPP240xxxMVHDB-10V-T-AUX
							VPP240xxxMVHDB-10V-YY
	✓	B		8.78	3.54	1.75	VPP240xxFVHDB-10V-T-Y
	✓	B		8.82	2.66	1.57	VPP240xxxMVHDB-10V-T-63
✓		A		9.70	2.68	1.70	VPP240xxxMVHDB-10V-Y
	✓	B		9.88	3.54	1.75	VPP320xxFVHDB-10V-T-Y
✓	✓	A		9.20	3.86	1.57	VPP320xxxMVHDB-10V-Y

LED
MODULES

LED
DRIVERS

LED
DRIVER CASES

LED
LAMPS

LED
RETROFIT KITS

LED EMERGENCY
BATTERY BACK UP

STEP-DOWN
TRANSFORMERS

CONTROL
OPTIONS

LED Drivers - Constant Voltage Part Number Break Down

Example part number:

VEV6012MVH-24

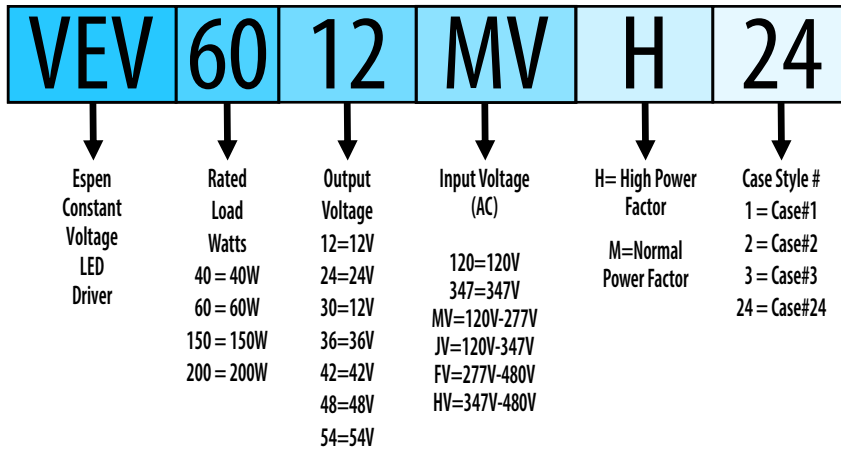

FEATURES AND BENEFITS

- Constant voltage design
- Active power factor correction on multi-volt models
- Dimming & non-dimming models
- 100% full load burn-in test
- 5 year warranty



LED DRIVERS - CONSTANT VOLTAGE

CONSTANT VOLTAGE							
MODEL #	MAX POWER (W)	Vin	DIMMING	EFFICIENCY AT NOMINAL LOAD	OUTPUT VOLTAGE MAX RANGE	OUTPUT CURRENT RANGE	MIN START TEMP
VEV12XXXMVH-51	12	120-277	N/A	80	12/24/48	1000	-25
VEV40XXXMVH-53	40	120-277	N/A	82-86	9/12/18/24/36/48	4450	-25
VEV6012/24MVH-10T-YY	60	100-277	Triac@120Vac /1-10V/PWM	80	12/24	5000/2500	-30
VEV75XXXMVH-Y	78	120-277	N/A	87	12/24/36/48	6250	-25
VEV96XXMVH-57	96	120-277	N/A	87-89	24/28/36/42/48/54	1770-4000	-25
VEV9624MVH-10T-YY	96	100-277	Triac@120Vac /1-10V/PWM	83	24	4000	-25
VEV100XXXMVH-Y	100	120-277	N/A	87-89	12/24/36/42/48/54/81/105	8330	-25
VEV120XXXMVH-59	120	120-277	N/A	87-89	24/28/36/42/48/54/81/105	1140-10000	-25
VEV150XXXMVH-Y	150	120-277	N/A	88-89	12/24/36/42/48/54/81/105	12500	-25
VEV200XXXMVH-Y	200	120-277	N/A	88-89	12/24/36/42/48/50/52/54/81/105	16670	-25
VEV320XXXMVH-Y	320	120-277	N/A	90	12/24/28/36/48/54	22000	-40

LED MODULES

LED DRIVERS

LED DRIVER CASES

LED LAMPS

LED RETROFIT KITS

LED EMERGENCY BATTERY BACK UP

STEP-DOWN TRANSFORMERS

CONTROL OPTIONS

LED DRIVERS - CONSTANT VOLTAGE

CONSTANT VOLTAGE								
IP RATING	UL-P	UL	FCC CLASS	CLASS2	LENGTH (L) IN INCHES	WIDTH (W) IN INCHES	HEIGHT (H) IN INCHES	MODEL #
IP66		✓	A		3.35	1.42	0.91	VEV12XXXMVH-51
IP66		✓	A		3.74	2.76	1.26	VEV40XXXMVH-53
IP25		✓	A	✓	7.56	2.76	1.34	VEV6012/24MVH-10T-YY
IP67		✓	A		6.46	2.68	1.54	VEV75XXXMVH-Y
IP67		✓	A		6.89	2.66	1.46	VEV96XXXMVH-57
IP25		✓	A		8.70	2.87	1.34	VEV9624MVH-10T-YY
IP67		✓	A		7.00	2.68	1.54	VEV100XXXMVH-Y
IP67		✓			7.28	2.66	1.46	VEV120XXXMVH-59
IP67		✓	A		8.15	2.68	1.54	VEV150XXXMVH-Y
IP67		✓	A		9.13	2.68	1.70	VEV200XXXMVH-Y
IP67		✓	A		9.20	3.86	1.57	VEV320XXXMVH-Y

LED
MODULES

LED
DRIVERS

LED
DRIVER CASES

LED
LAMPS

LED
RETROFIT KITS

LED EMERGENCY
BATTERY BACK UP

STEP-DOWN
TRANSFORMERS

CONTROL
OPTIONS

LED DRIVER CASES

Case Dimension Index

Line Drawings

Case 2
Qty: 100PCS

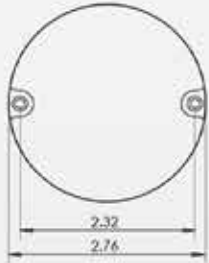

Case 3
Qty: 100PCS

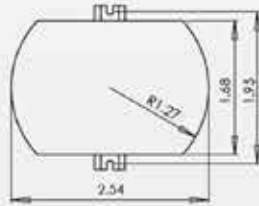
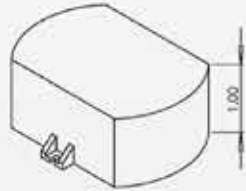

Case 4
Qty: 60PCS

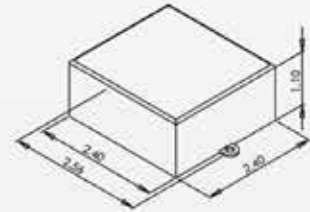

Case 5
Qty: 60PCS

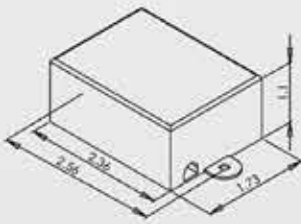

Case 11

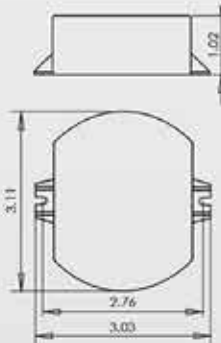

Case 13

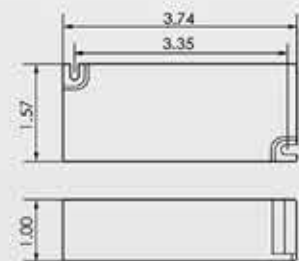

LED DRIVER CASES

Case Dimension Index Line Drawings

LED
MODULES

LED
DRIVERS

LED
DRIVER CASES

LED
LAMPS

LED
RETROFIT KITS

LED EMERGENCY
BATTERY BACK UP

STEP-DOWN
TRANSFORMERS

CONTROL
OPTIONS

Case 25
Qty: 40PCS

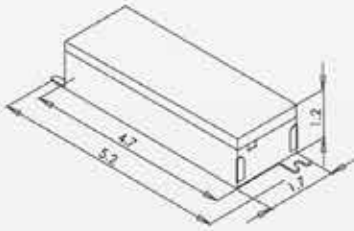

Case 27
Qty: 30PCS

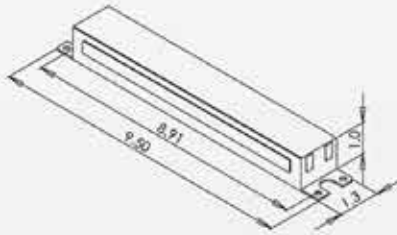

Case 29

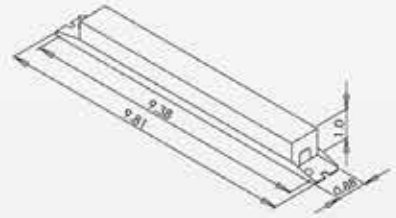

Case 32

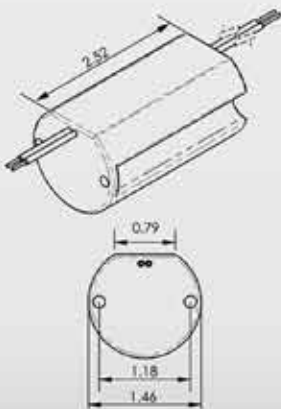

Case 33

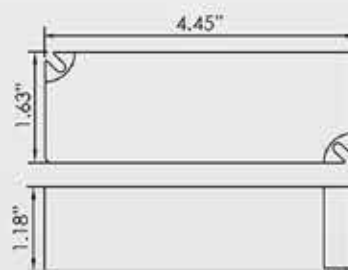

Case 35
Qty: 25PCS

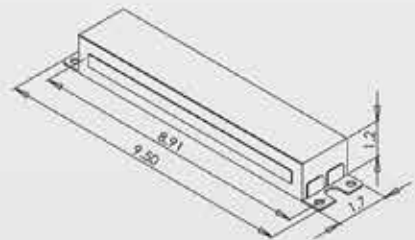

LED DRIVER CASES

LED
MODULES

Case Dimension Index

Line Drawings

LED
DRIVERS

Case 42
Qty: 30PCS

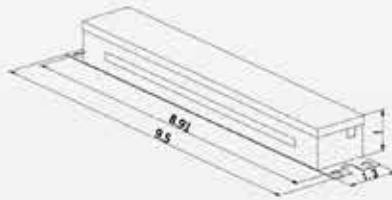

Case 43
Qty: 50PCS

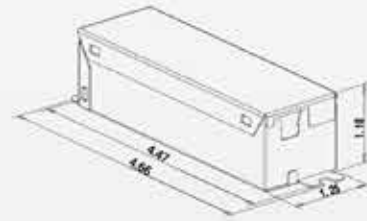

Case 47
Qty: 30PCS

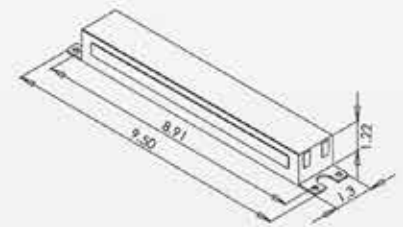

LED
DRIVER CASES

LED
LAMPS

LED
RETROFIT KITS

Case 51
Qty: 125PCS

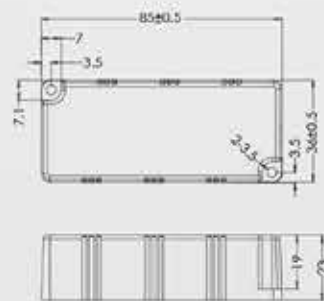

Case 52
Qty: 50PCS

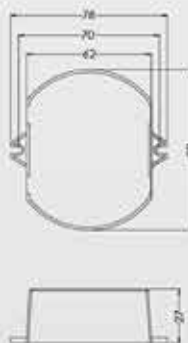

Case 53
Qty: 25PCS

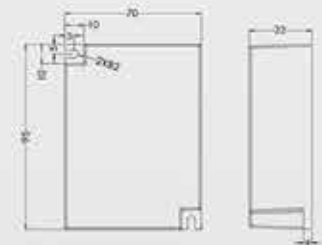

LED EMERGENCY
BATTERY BACK UP

STEP-DOWN
TRANSFORMERS

CONTROL
OPTIONS

LED DRIVER CASES

Case Dimension Index Line Drawings

LED
MODULES

LED
DRIVERS

LED
DRIVER CASES

LED
LAMPS

LED
RETROFIT KITS

LED EMERGENCY
BATTERY BACK UP

STEP-DOWN
TRANSFORMERS

CONTROL
OPTIONS

Case 54
Qty: 20PCS

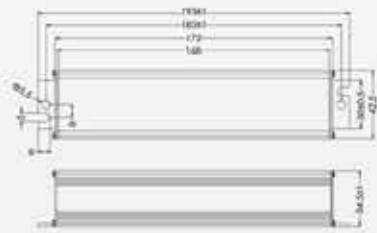

Case 55
Qty: 10PCS



Case 57
Qty: 10PCS



Case 58
Qty: 10PCS

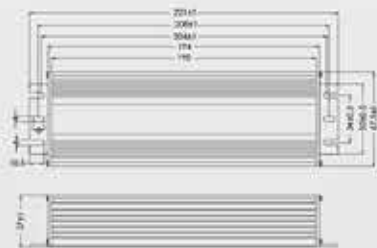

Case 59
Qty: 10PCS



Case 62
Qty: 10PCS



LED DRIVER CASES

LED
MODULES

Case Dimension Index Line Drawings

LED
DRIVERS

Case 63
Qty: 10PCS

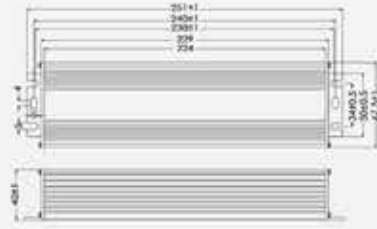

Case 64
Qty: 5PCS



Case 65
Qty: 5PCS

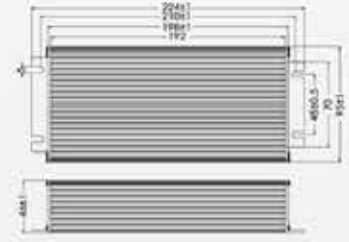

LED
DRIVER CASES

LED
LAMPS

LED
RETROFIT KITS

Case 66
Qty: 10PCS



Case 67
Qty: 10PCS



Case 68
Qty: 10PCS



LED EMERGENCY
BATTERY BACK UP

STEP-DOWN
TRANSFORMERS

CONTROL
OPTIONS

LED DRIVER CASES

Case Dimension Index

Line Drawings

LED
MODULES

LED
DRIVERS

LED
DRIVER CASES

LED
LAMPS

LED
RETROFIT KITS

LED EMERGENCY
BATTERY BACK UP

STEP-DOWN
TRANSFORMERS

CONTROL
OPTIONS

Case 69
Qty: 5PCS



Case 70
Qty: 5PCS



Case 71
Qty: 40PCS



Case 72
BA/96L/6.0AH



Case 73
BA/96L/3.0AH

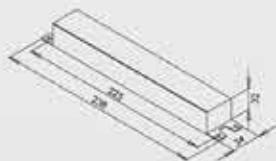

Case 74
BA/96L/1.5AH



Retroflex LED Lamp Driver
Non-Dimmable

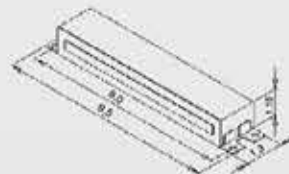

Retroflex LED Lamp Driver
0-10V Dimming



LED LAMPS

Flex™

LED LAMPS WITH INTERNAL DRIVER | Type B

LED
MODULES

LED
DRIVERS

LED
DRIVER CASES

LED
LAMPS

LED
RETROFIT KITS

LED EMERGENCY
BATTERY BACK UP

STEP-DOWN
TRANSFORMERS

CONTROL
OPTIONS



compact LED

Internal Driver, Convenient Installation, Instant on with no delay or warm up time, High CRI, 5 year warranty



linear LED

Med. Bi-pin, Internal Driver, DLC Listed, Glass tube for superior optical performance, Utilizes unshunted (rapid start) sockets, Long Life *Also available in 0-10V dimming

360° Sign Lamps LED

NEED INFORMATION



HID Lamps LED

NEED INFORMATION



LED FT lamps LED

Utilizes current 2G11 sockets, Internal Driver, Compatible with controls and sensors, Instant On



Flex™
LED Solutions
with Internal Driver



accessories

PLL Brackets, PLL Lamp Sockets, Unshunted sockets, G13, CFQ sockets



emergency inverter

90 Minute Illumination Time



Espen Flex LED Lamps

Espen Flex LED lamps have an internal driver that frees linear luminaires from old fluorescent ballasts and lamps. The lamp works directly off of line input voltage 120/277V. Flex lamps make convenient and effective retrofit solutions for any old T12 system, especially with magnetic ballasts. Simply remove the old fluorescent ballast and wire line voltage directly to one side of the unshunted lamp holder. Flex lamps can save you up to 50% of system power, while maintaining or increasing illumination levels. Flex lamps come in a range of sizes, including linear 2ft, 3ft, 4ft, 5ft, 6ft, and 8ft.

Flex™ DE

AC Direct Input HO LED T5 Lamps | Double End Input



FEATURES AND BENEFITS

- Double Ended Bypass Connection
- Internal Driver
- Glass Tube for Optimal Light Output and Heat Dissipation
- -20° F to 130° F Ambient Operating Temperature
- Frosted to Prevent Glare
- Suitable for Damp Locations
- 240° Wide Beam Angle
- 5 Year Warranty



WIRING DIAGRAM

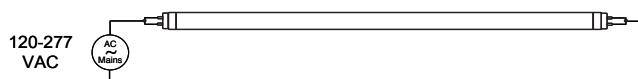

Model No.	Replaces	Length (in)	Lamp Power (W)	Lumens (lm)	Lamp Efficacy (lm/W)	Voltage (V)	CCT (K)	CRI	Life (h)
HO Linear T5									
L48T5/830/25G-ID DE	F54T5HO	48	25	3500	140	120 - 277	3000+	80+	50000
L48T5/835/25G-ID DE	F54T5HO	48	25	3500	140	120 - 277	3500	80+	50000
L48T5/840/25G-ID DE	F54T5HO	48	25	3500	140	120 - 277	4000	80+	50000
L48T5/850/25G-ID DE	F54T5HO	48	25	3500	140	120 - 277	5000	80+	50000

+ 3000K CCT may be subject to lead times and availability.



LED LAMPS

LED
MODULES

Flex™

AC Direct Input LED T8 Lamps | Single End Input 0-10V Dimming

LED
DRIVERS



FEATURES AND BENEFITS

- Single Ended Bypass Connection with Non-Shunted Tombstones
- 0-10 Dimmable
- Internal Driver
- Glass Tube for Optimal Light Output and Heat Dissipation
- -20° F to 130° F Ambient Operating Temperature
- Frosted to Prevent Glare
- Suitable for Damp Locations
- 325° Wide Beam Angle
- 5 Year Warranty



NO
Shunted
Instant Start Socket



YES
Unshunted
Rapid Start Socket

WIRING DIAGRAM



LED
LAMPS

LED
RETROFIT KITS

Model No.	Replaces	Length (in)	Lamp Power (W)	Lumens (lm)	Lamp Efficacy (lm/W)	Input Voltage (V)	CCT (K)	CRI	Life (h)
Linear T8									
L24T8/830/9G-ID-10V	F17T8	24	9	1100	122	120 - 277	3000+	83+	50000
L24T8/835/9G-ID-10V	F17T8	24	9	1100	122	120 - 277	3500	83+	50000
L24T8/840/9G-ID-10V	F17T8	24	9	1100	122	120 - 277	4000	83+	50000
L24T8/850/9G-ID-10V	F17T8	24	9	1100	122	120 - 277	5000	83+	50000
L36T8/830/12G-ID-10V ¹	F25T8	36	12	1400	117	120 - 277	3000+	83+	50000
L36T8/835/12G-ID-10V ¹	F25T8	36	12	1400	117	120 - 277	3500	83+	50000
L36T8/840/12G-ID-10V ¹	F25T8	36	12	1400	117	120 - 277	4000	83+	50000
L36T8/850/12G-ID-10V ¹	F25T8	36	12	1400	117	120 - 277	5000	83+	50000
L48T8/830/14G-ID-10V	F32T8	48	14	1800	129	120 - 277	3000+	83+	50000
L48T8/835/14G-ID-10V	F32T8	48	14	1800	129	120 - 277	3500	83+	50000
L48T8/840/14G-ID-10V	F32T8	48	14	1800	129	120 - 277	4000	83+	50000
L48T8/850/14G-ID-10V	F32T8	48	14	1800	129	120 - 277	5000	83+	50000
L48T8/830/17G-ID-10V	F32T8	48	18	2200	129	120 - 277	3000+	83+	50000
L48T8/835/17G-ID-10V	F32T8	48	18	2200	129	120 - 277	3500	83+	50000
L48T8/840/17G-ID-10V	F32T8	48	18	2200	129	120 - 277	4000	83+	50000
L48T8/850/17G-ID-10V	F32T8	48	18	2200	129	120 - 277	5000	83+	50000

¹ Not DLC listed. DLC does not regulate 3 foot lamps.
+ 3000K CCT may be subject to lead times and availability.

LED
BATTERY BACKUP

STEP-DOWN
TRANSFORMERS

CONTROL
OPTIONS

Flex™

Linear T8 Lamps | Double End Input

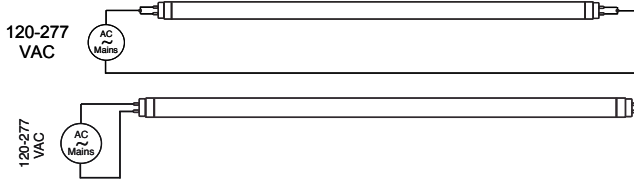

FEATURES AND BENEFITS

- Double Ended Bypass Connection with Shunted or Non-Shunted Tombstones
- Internal Driver
- Glass Tube for Optimal Light Output and Heat Dissipation
- -20° F to 130° F Ambient Operating Temperature
- Instant on, No delay
- Convenient and quick installation
- Frosted to Prevent Glare
- Suitable for Damp Locations
- 325° Wide Beam Angle
- 5 Year Warranty



Model No.	Replaces	Length (in)	Lamp Power (W)	Lumens (lm)	Lamp Efficacy (lm/W)	Input Voltage (V)	CCT (K)	CRI	Life (h)
Linear T8									
L24T8/830/9G-ID DE	F17T8	24	9	1100	122	120 - 277	3000+	83+	50000
L24T8/835/9G-ID DE	F17T8	24	9	1100	122	120 - 277	3500	83+	50000
L24T8/840/9G-ID DE	F17T8	24	9	1100	122	120 - 277	4000	83+	50000
L24T8/850/9G-ID DE	F17T8	24	9	1100	122	120 - 277	5000	83+	50000
L36T8/830/12G-ID DE	F25T8	36	12	1400	117	120 - 277	3000+	83+	50000
L36T8/835/12G-ID DE	F25T8	36	12	1400	117	120 - 277	3500	83+	50000
L36T8/840/12G-ID DE	F25T8	36	12	1400	117	120 - 277	4000	83+	50000
L36T8/850/12G-ID DE	F25T8	36	12	1400	117	120 - 277	5000	83+	50000
L48T8/830/14G-ID DE	F32T8	48	14	1800	129	120 - 277	3000+	83+	50000
L48T8/835/14G-ID DE	F32T8	48	14	1800	129	120 - 277	3500	83+	50000
L48T8/840/14G-ID DE	F32T8	48	14	1800	129	120 - 277	4000	83+	50000
L48T8/850/14G-ID DE	F32T8	48	14	1800	129	120 - 277	5000	83+	50000
L48T8/830/17G-ID DE	F32T8	48	17	2200	122	120 - 277	3000+	83+	50000
L48T8/835/17G-ID DE	F32T8	48	17	2200	122	120 - 277	3500	83+	50000
L48T8/840/17G-ID DE	F32T8	48	17	2200	122	120 - 277	4000	83+	50000
L48T8/850/17G-ID DE	F32T8	48	17	2200	122	120 - 277	5000	83+	50000

+ May be subject to lead times and availability.

LED LAMPS

LED
MODULES

Flex™ ArmorCoat™

AC Direct Input Slimline LED T8 Lamps | Double End Input

LED
DRIVERS

LED
DRIVER CASES

LED
LAMPS

LED
RETROFIT KITS

LED EMERGENCY
BATTERY BACKUP

STEP-DOWN
TRANSFORMERS

CONTROL
OPTIONS



Anti-Rotation Bracket for 8ft

FEATURES AND BENEFITS

- Double Ended Bypass Connection
- Internal Driver
- **ArmorCoat™** Shatterproof Coating
- Glass Tube for Optimal Light Output and Heat Dissipation
- -20° F to 130° F Ambient Operating Temperature
- Bracket Included
- Frosted to Prevent Glare
- Suitable for Damp Locations
- 325° Wide Beam Angle
- 5 Year Warranty



WIRING DIAGRAM

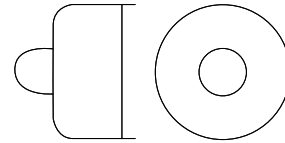
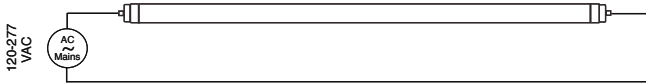

Fa8 Base
Single Pin

Model No.	Base Type	Replaces	Length (in)	Lamp Power (W)	Lumens (lm)	Lamp Efficacy (lm/W)	Input Voltage (V)	CCT (K)	CRI	Life (h)
Slimline Linear T8										
L60T8SL/830/15G-ID DE	FA8	F60T8, F60T12	60	15	2200	147	120 - 277	3000+	83+	50000
L60T8SL/835/15G-ID DE	FA8	F60T8, F60T12	60	15	2200	147	120 - 277	3500+	83+	50000
L60T8SL/840/15G-ID DE	FA8	F60T8, F60T12	60	15	2200	147	120 - 277	4000+	83+	50000
L60T8SL/850/15G-ID DE	FA8	F60T8, F60T12	60	15	2200	147	120 - 277	5000+	83+	50000
L72T8SL/830/18G-ID DE	FA8	F72T8, F72T12	72	18	2700	150	120 - 277	3000+	83+	50000
L72T8SL/835/18G-ID DE	FA8	F72T8, F72T12	72	18	2700	150	120 - 277	3500+	83+	50000
L72T8SL/840/18G-ID DE	FA8	F72T8, F72T12	72	18	2700	150	120 - 277	4000+	83+	50000
L72T8SL/850/18G-ID DE	FA8	F72T8, F72T12	72	18	2700	150	120 - 277	5000+	83+	50000
L96T8/830/24G-ID DE	FA8	F96T8, F96T12	96	24	3500	146	120 - 277	3000+	83+	50000
L96T8/835/24G-ID DE	FA8	F96T8, F96T12	96	24	3500	146	120 - 277	3500	83+	50000
L96T8/840/24G-ID DE	FA8	F96T8, F96T12	96	24	3500	146	120 - 277	4000	83+	50000
L96T8/850/24G-ID DE	FA8	F96T8, F96T12	96	24	3500	146	120 - 277	5000	83+	50000
L96T8HO/830/42G-ID DE	FA8	F96T8, F96T12	96	42	5500	131	120 - 277	3000+	83+	50000
L96T8HO/835/42G-ID DE	FA8	F96T8, F96T12	96	42	5500	131	120 - 277	3500	83+	50000
L96T8HO/840/42G-ID DE	FA8	F96T8, F96T12	96	42	5500	131	120 - 277	4000	83+	50000
L96T8HO/850/42G-ID DE	FA8	F96T8, F96T12	96	42	5500	131	120 - 277	5000	83+	50000

+ May be subject to lead times and availability.

Flex™ ArmorCoat™

AC Direct Input HO/VHO LED T8 Lamps | Double End Input



FEATURES AND BENEFITS

- Double Ended Bypass Connection
- Internal Driver
- **ArmorCoat™** Shatterproof Coating
- Glass Tube for Optimal Light Output and Heat Dissipation
- -20° F to 130° F Ambient Operating Temperature
- Integrated Thermal Fuse Protection
- Frosted to Prevent Glare
- Suitable for Damp Locations
- 325° Wide Beam Angle
- 5 Year Warranty



WIRING DIAGRAM

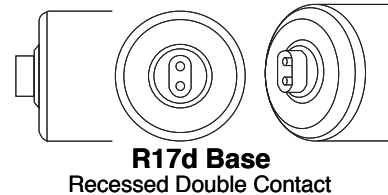
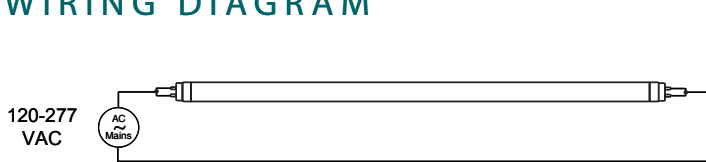

Model No.	Base Type	Replaces	Length (in)	Lamp Power (W)	Lumens (lm)	Lamp Efficacy (lm/W)	Input Voltage (V)	CCT (K)	CRI	Life (h)
HO/VHO Linear T8										
L60T8HO/830/15G-ID DE	R17d	F60T12 HO/VHO	60	15	2200	147	120 - 277	3000+	83+	50000
L60T8HO/835/15G-ID DE	R17d	F60T12 HO/VHO	60	15	2200	147	120 - 277	3500+	83+	50000
L60T8HO/840/15G-ID DE	R17d	F60T12 HO/VHO	60	15	2200	147	120 - 277	4000+	83+	50000
L60T8HO/850/15G-ID DE	R17d	F60T12 HO/VHO	60	15	2200	147	120 - 277	5000+	83+	50000
L72T8HO/830/18G-ID DE	R17d	F72T12 HO/VHO	72	18	2700	150	120 - 277	3000+	83+	50000
L72T8HO/835/18G-ID DE	R17d	F72T12 HO/VHO	72	18	2700	150	120 - 277	3500+	83+	50000
L72T8HO/840/18G-ID DE	R17d	F72T12 HO/VHO	72	18	2700	150	120 - 277	4000+	83+	50000
L72T8HO/850/18G-ID DE	R17d	F72T12 HO/VHO	72	18	2700	150	120 - 277	5000+	83+	50000
L96T8HO/830/42G-ID DE	R17d	F96T8, F96T12 HO/VHO	96	42	5500	131	120 - 277	3000+	83+	50000
L96T8HO/835/42G-ID DE	R17d	F96T8, F96T12 HO/VHO	96	42	5500	131	120 - 277	3500	83+	50000
L96T8HO/840/42G-ID DE	R17d	F96T8, F96T12 HO/VHO	96	42	5500	131	120 - 277	4000	83+	50000
L96T8HO/850/42G-ID DE	R17d	F96T8, F96T12 HO/VHO	96	42	5500	131	120 - 277	5000	83+	50000

+ May be subject to lead times and availability.

LED LAMPS

LED
MODULES

Flex™

LED FT Lamps

LED
DRIVERS

LED
DRIVER CASES

LED
LAMPS

LED
RETROFIT KITS

LED
EMERGENCY
BATTERY BACKUP

STEP-DOWN
TRANSFORMERS

CONTROL
OPTIONS



FEATURES AND BENEFITS

- Internal Driver
- Smooth, Consistent Light
- UL for Safety
- No UV, No Mercury
- Long Life
- High CRI
- Instant on, no delay or warm up time
- Convenient and quick installation
- Utilizes current lamp sockets
- Compatible with controls and sensors
- -20° F to 130° F Ambient Operating Temperature
- 5 Year Warranty



Model No.	Replaces	Lamp Power (W)	Lumens (lm)	Lamp Efficacy (lm/W)	Input Voltage (V)	CCT (K)	CRI	Life (h)
Compact LED Lamps								
LT18W/835-ID	FT18W	8	640	80	120 - 277	3500	83+	50000
LT18W/840-ID	FT18W	8	640	80	120 - 277	4000	83+	50000
LT18W/850-ID	FT18W	8	640	80	120 - 277	5000	83+	50000
LT24W/835-ID	FT24W	10	800	80	120 - 277	3500	83+	50000
LT24W/840-ID	FT24W	10	800	80	120 - 277	4000	83+	50000
LT24W/850-ID	FT24W	10	800	80	120 - 277	5000	83+	50000
LT36W/835-ID	FT36W	15	1200	80	120 - 277	3500	83+	50000
LT36W/840-ID	FT36W	15	1200	80	120 - 277	4000	83+	50000
LT36W/850-ID	FT36W	15	1200	80	120 - 277	5000	83+	50000
LT40W/835-ID	FT40W/FT55W	18	1800	80	120 - 277	3500	83+	50000
LT40W/840-ID	FT40W/FT55W	18	1800	80	120 - 277	4000	83+	50000
LT40W/850-ID	FT40W/FT55W	18	1800	80	120 - 277	5000	83+	50000

WIRING DIAGRAM

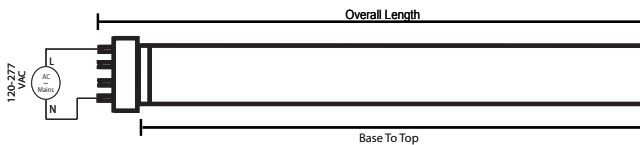

LT series	Overall Length (mm)	Base Face to Top (mm)
Dimensions		
LT40	540	493
LT36	421	374
LT24	326	278
LT18	231	183

Flex™

AC Direct Input Compact LED Lamps | Single End Input



FEATURES AND BENEFITS

- Compatible with 2-Pin and 4-Pin Sockets
- Internal Driver
- -20° F to 130° F Ambient Operating Temperature
- Frosted to Prevent Glare
- Suitable for Damp Locations
- 5 Year Warranty



Model No.	Replaces	Lamp Power (W)	Lumens (lm)	Lamp Efficacy (lm/W)	Input Voltage (V)	CCT (K)	CRI	Life (h)
Compact LED Lamps								
CLD18WH/830-ID	18W, 26W, 32W, 42W CFQ	8	950	118	120 - 277	3000+	83+	50000
CLD18WH/835-ID	18W, 26W, 32W, 42W CFQ	8	950	118	120 - 277	3500	83+	50000
CLD18WH/840-ID	18W, 26W, 32W, 42W CFQ	8	950	118	120 - 277	4000	83+	50000
CLD18WH/850-ID	18W, 26W, 32W, 42W CFQ	8	950	118	120 - 277	5000	83+	50000
CLD18WV/830-ID	18W, 26W, 32W, 42W CFQ	8	950	118	120 - 277	3000+	83+	50000
CLD18WV/835-ID	18W, 26W, 32W, 42W CFQ	8	950	118	120 - 277	3500	83+	50000
CLD18WV/840-ID	18W, 26W, 32W, 42W CFQ	8	950	118	120 - 277	4000	83+	50000
CLD18WV/850-ID	18W, 26W, 32W, 42W CFQ	8	950	118	120 - 277	5000	83+	50000

+ May be subject to lead times and availability.



LED LAMPS

LED MODULES

Flex™

360° Sign Lamps

LED DRIVERS



LED DRIVER CASES

FEATURES AND BENEFITS

- Double-sided Design Sign Light
- 360° Beam Angle
- Rotatable End Caps
- Internal Driver
- Compatible with Sensors
- Instant On, No Delay or Warm Up Time
- Convenient and Quick Installation
- Input from Both Ends
- Utilizes R17d Sockets
- Works in Cold Temperature Applications
- Plastic tube is shatterproof
- No UV, No Mercury
- UL for Safety
- High CRI
- 5 Year Warranty



LED LAMPS

Model No.	Length	Base Type	Lamp Wattage	Input Voltage (V)	CCT (K)	Initial Lumens	CRI	Beam Angle	Lamp Efficacy (lm/W)	Power Factor	THD
360° Sign Lamps											
LS48T8HO/840/21P-ID DE	48	R17d	21	120 - 277	4000	2500	83+	360	120	>0.90	<20%
LS48T8HO/865/21P-ID DE	48	R17d	21	120 - 277	6500	2500	83+	360	120	>0.90	<20%
LS60T8HO/840/25P-ID DE	60	R17d	25	120 - 277	4000	3125	83+	360	120	>0.90	<20%
LS60T8HO/865/25P-ID DE	60	R17d	25	120 - 277	6500	3125	83+	360	120	>0.90	<20%
LS72T8HO/840/32P-ID DE	72	R17d	32	120 - 277	4000	3750	83+	360	120	>0.90	<20%
LS72T8HO/865/32P-ID DE	72	R17d	32	120 - 277	6500	3750	83+	360	120	>0.90	<20%
LS96T8HO/840/42P-ID DE	96	R17d	42	120 - 277	4000	5000	83+	360	120	>0.90	<20%
LS96T8HO/865/42P-ID DE	96	R17d	42	120 - 277	6500	5000	83+	360	120	>0.90	<20%

LED RETROFIT KITS

WIRING DIAGRAM

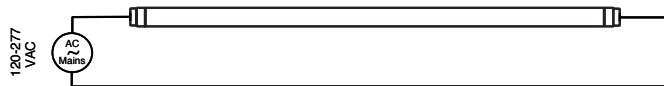

LED EMERGENCY BATTERY BACK UP

STEP-DOWN TRANSFORMERS

CONTROL OPTIONS

Flex™

HID Replacement Lamps



DAMP LOCATION



WET LOCATION

FEATURES AND BENEFITS

- High Efficiency, >130lm/w
- Damp location HID, 4KV Surge Protection
- Wet location HID, IP65, 4KV Surge Protection
- Approved for Totally Enclosed Fixture
- Excellent Thermal Design of Chimney Effect
- Voltage 120-277V
- Internal Driver
- Smooth, Consistent Light
- UL for Safety
- No UV, No Mercury
- Long Life
- High CRI
- Convenient and Quick Installation
- 5 Year Warranty
- Superior Wide View Angle



Damp Location HID Lamp						
Model No.	Watt	Equal to HID	Lumen	_s CRI	Base	Dimensions (mm)
HDE70/8XX/18W-ID	18	70	2300	80	E26E	26 dia. 60 X 173
HDE100/8XX/27W-ID	27	100	3510	80	E26/E39E	26 dia. 70 X 184
HDM100/8XX/27W-ID	27	100	3510	80	E26/E39E	26 dia. 70 X 193
HDE150/8XX/36W-ID	36	150	4680	80	E26/E39E	26 dia. 90 X 239
HDM150/8XX/36W-ID	36	150	4680	80	E26/E39E	39 dia. 90 X 239
HDE175/8XX/45W-ID	45	175	6000	80	E26/E39E	26 dia. 90 X 239
HDM175/8XX/45W-ID	45	175	6000	80	E26/E39E	39 dia. 90 X 239
HDE250/8XX/54W-ID	54	250	7020	80	E26/E39E	26 dia. 90 X 236
HDM250/8XX/54W-ID	54	250	7020	80	E26/E39E	39 dia. 90 X 245
HDM320/8XX/80W-ID	80	320	10400	80	E39E	39 dia. 124 X 259
HDM400/8XX/10W-ID	100	400	13000	80	E39E	39 dia. 150 X 269

Wet Location HID Lamps IP65						
Model No.	Watt	Equal to HID	Lumen	CRI	Base	Dimensions (mm)
HDE70/8XX/18W-ID WP	18	70	2300	80	E26E	26 dia. 70 X 175
HDE100/8XX/27W-ID WP	27	100	3510	80	E26E	26 dia. 70 X 190
HDE150/8XX/36W-ID WP	36	150	4680	80	E26/E39E	26 dia. 90 X 220
HDM150/8XX/36W-ID WP	36	150	4680	80	E26/E39E	39 dia. 70 X 229
HDE175/8XX/45W-ID WP	45	175	6000	80	E26/E39E	26 dia. 90 X 235
HDM175/8XX/45W-ID WP	45	175	6000	80	E26/E39E	39 dia. 70 X 244
HDE250/8XX/54W-ID WP	54	250	7020	80	E26/E39E	26 dia. 90 X 250
HDM250/8XX/54W-ID WP	54	250	7020	80	E26/E39E	39 dia. 90 X 259
HDM320/8XX/80W-ID WP	80	320	10400	80	E39E	39 dia. 110 X 269
HDE400/8XX/100W-ID WP	100	400	13000	80	E39E	39 dia. 130 X 278

LED LAMPS

LED
MODULES



LED LAMP WITH EXTERNAL DRIVER | Type C

LED
DRIVERS



linear^{LED}

G13 or G5, External Driver
Dimmable, Long Life, Convenient Wiring



LED
DRIVER CASES

driver^{LED}

Constant Current
Multi-Channel 0-10V & power line dimming
Available in Programmable & Field Adjustable



LED
LAMPS

emergency driver

Constant light output,
Auto LED load sensing



LED
RETROFIT KITS

LED programmer

Adjusts drivers' power, current,
dimming levels and delay timer



module^{LED}

Safe Push-in Connection, Dimmable,
Long Life, Uniform Light Distribution,
Complete Thermal Solution, Suitable for
DLC applications

LED
EMERGENCY
BATTERY BACK UP

STEP-DOWN
TRANSFORMERS

CONTROL
OPTIONS

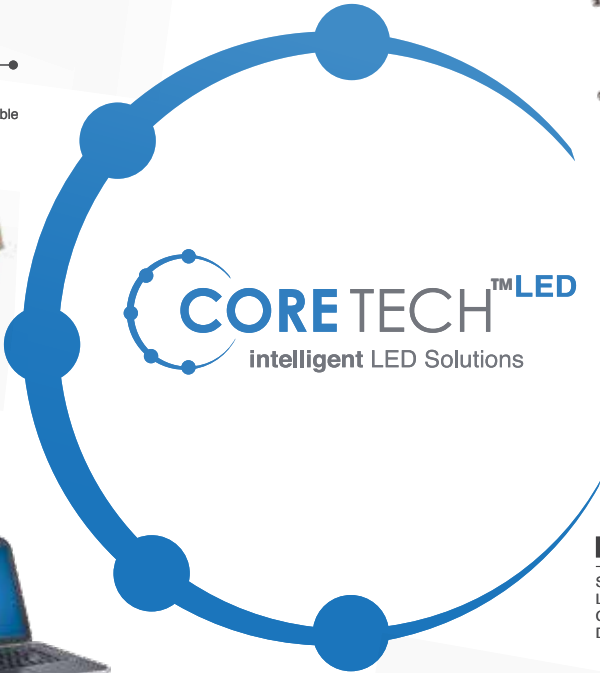

ESPEN CORETECH LED SYSTEM

LED lamps with external driver for full controllability Espen's CoreTech LED system consists of industry-leading LED lamps and programmable multi-channel drivers. The CoreTech system utilizes the exact same wiring diagram as fluorescent ballasts. The upgrade is handled the same as replacing an electronic ballast and lamps. Your facility can save up to 50% of system power while maintaining or increasing illumination levels.

The CoreTech multi-channel design permits all lamps to work independently to prevent total darkness when one lamp fails. The user-friendly programmability allows you to set the same system for normal output, high output, or low output, to match your application requirements.

LED LAMPS



LED T5 HE & HO LAMP WITH EXTERNAL DRIVER | Type C



FEATURES AND BENEFITS

- No Polarity, Lamp Ends Can Be Reversed
- Compatible with Controls and Sensors
- Glass Tube for Optimal Light Output and Heat Dissipation
- 50,000 Hours Life with No Limitation on On/Off Cycles
- -20° F to 130° F Ambient Operating Temperature
- 1 or 2 Lamps Compatible with Espen VPL50 LED Driver¹
- 3 or 4 Lamps Compatible with Espen VPL100 LED Driver¹
- 240° Wide Beam Angle
- Dimmable
- 5 Year Warranty



Model No.	Length (in)	Driver Current	Replaces	Lamp Power (W)	System Power (W)	Lumens (lm)	Lamp Efficacy (lm/W)	Lamp Voltage (V)	CCT (K)	CRI	Life (h)	Current Settings
Linear T8												
L24T5/830/11G-XT	24	Normal	F14TSHE	9	12	1300	144	120 - 277	3000+	82+	50000	360mA
		High	F24TSHO	12	15	1700	142	120 - 277	3500	82+	50000	500mA
L24T5/835/11G-XT	24	Normal	F14TSHE	9	12	1300	144	120 - 277	3000+	82+	50000	360mA
		High	F24TSHO	12	15	1700	142	120 - 277	3500	82+	50000	500mA
L24T5/840/11G-XT	24	Normal	F14TSHE	9	12	1300	144	120 - 277	4000	82+	50000	360mA
		High	F24TSHO	12	15	1700	142	120 - 277	4000	82+	50000	500mA
L24T5/850/11G-XT	24	Normal	F14TSHE	9	12	1300	144	120 - 277	5000	82+	50000	360mA
		High	F24TSHO	12	15	1700	142	120 - 277	5000	82+	50000	500mA
L36T5/830/18G-XT	36	Normal	F21TSHE	13	16	1900	146	120 - 277	3000+	82+	50000	360mA
		High	F39TSHO	18	21	2500	139	120 - 277	3000+	82+	50000	500mA
L36T5/835/18G-XT	36	Normal	F21TSHE	13	16	1900	146	120 - 277	3500	82+	50000	360mA
		High	F39TSHO	18	21	2500	139	120 - 277	3500	82+	50000	500mA
L36T5/840/18G-XT	36	Normal	F21TSHE	13	16	1900	146	120 - 277	4000	82+	50000	360mA
		High	F39TSHO	18	21	2500	139	120 - 277	4000	82+	50000	500mA
L36T5/850/18G-XT	36	Normal	F21TSHE	13	16	1900	146	120 - 277	5000	82+	50000	360mA
		High	F39TSHO	18	21	2500	139	120 - 277	5000	82+	50000	500mA
L48T5/830/24G-XT	48	Normal	F28TSHE	15	18	2300	153	120 - 277	3000+	82+	50000	360mA
		High	F54TSHO	24	27	3300	138	120 - 277	3000+	82+	50000	500mA
L48T5/835/24G-XT	48	Normal	F28TSHE	15	18	2300	153	120 - 277	3500	82+	50000	360mA
		High	F54TSHO	24	27	3300	138	120 - 277	3500	82+	50000	500mA
L48T5/840/24G-XT	48	Normal	F28TSHE	15	18	2300	153	120 - 277	4000	82+	50000	360mA
		High	F54TSHO	24	27	3300	138	120 - 277	4000	82+	50000	500mA
L48T5/850/24G-XT	48	Normal	F28TSHE	15	18	2300	153	120 - 277	5000	82+	50000	360mA
		High	F54TSHO	24	27	3300	138	120 - 277	5000	82+	50000	500mA

¹ See VPL50 and VPL100 specifications.

+ 3000K CCT may be subject to lead times and availability.

LED LAMPS



LED T8 LAMP WITH EXTERNAL DRIVER | Type C



FEATURES AND BENEFITS

- No Polarity, Lamp Ends Can Be Reversed
- -20° F to 130° F Ambient Operating Temperature
- Glass Tube for Optimal Light Output and Heat Dissipation
- 50,000 Hours Life with No Limitation on On/Off Cycles
- 1 or 2 Lamps Compatible with Espen VPL50 LED Driver¹
- 3 or 4 Lamps Compatible with Espen VPL100 LED Driver¹
- 325° Wide Beam Angle
- Dimmable
- 5 Year Warranty



Model No.	Length (in)	Driver Current	Replaces	Lamp Power (W)	System Power (W)	Lumens (lm)	Lamp Efficacy (lm/W)	Lamp Voltage (V)	CCT (K)	CRI	Life (h)	Current Settings
Linear T8												
L24T8/830/8G-XT	24	Normal	F17T8	8	11	1200	150	120 - 277	3000+	82+	50000	300mA
		High		10	13	1400	140					360mA
L24T8/835/8G-XT	24	Normal	F17T8	8	11	1200	150	120 - 277	3500	82+	50000	300mA
		High		10	13	1400	140					360mA
L24T8/840/8G-XT	24	Normal	F17T8	8	11	1200	150	120 - 277	4000	82+	50000	300mA
		High		10	13	1400	140					360mA
L24T8/850/8G-XT	24	Normal	F17T8	8	11	1200	150	120 - 277	5000	82+	50000	300mA
		High		10	13	1400	140					360mA
L36T8/830/11G-XT	36	Normal	F25T8	11	14	1600	145	120 - 277	3000+	82+	50000	300mA
		High		13	16	1900	146					360mA
L36T8/835/11G-XT	36	Normal	F25T8	11	14	1600	145	120 - 277	3500	82+	50000	300mA
		High		13	16	1900	146					360mA
L36T8/840/11G-XT	36	Normal	F25T8	11	14	1600	145	120 - 277	4000	82+	50000	300mA
		High		13	16	1900	146					360mA
L36T8/850/11G-XT	36	Normal	F25T8	11	14	1600	145	120 - 277	5000	82+	50000	300mA
		High		13	16	1900	146					360mA
L48T8/830/15G-XT	48	Normal	F32T8	12	15	1800	150	120 - 277	3000+	82+	50000	300mA
		High		15	18	2200	146					360mA
L48T8/835/15G-XT	48	Normal	F32T8	12	15	1800	150	120 - 277	3500	82+	50000	300mA
		High		15	18	2200	146					360mA
L48T8/840/15G-XT	48	Normal	F32T8	12	15	1800	150	120 - 277	4000	82+	50000	300mA
		High		15	18	2200	146					360mA
L48T8/850/15G-XT	48	Normal	F32T8	12	15	1800	150	120 - 277	5000	82+	50000	300mA
		High		15	18	2200	146					360mA

¹ See VPL50 and VPL100 specifications.

+ May be subject to lead times and availability.

LED LAMPS



Programmable LED Driver for Type-C LED's | Type C



VPL50



VPL100

FEATURES AND BENEFITS

- Programmable Drive Current Range (300 - 600mA)
- For Use with 1 or 2 Espen CoreTech™ LED T5 or T8 Lamps
- Constant Current | 2 Channels
- Output Voltage: 25-50V DC
- Universal Voltage (120 - 277V)
- Dimmable
- Suitable for Damp Locations
- 5 Year Warranty



- Programmable Drive Current Range (200 - 500mA)
- For Use with 3 or 4 Espen CoreTech™ LED T5 or T8 Lamps
- Constant Current | 4 Channels
- Output Voltage: 25-50V DC
- Universal Voltage (120 - 277V)
- Dimmable
- Suitable for Damp Locations
- 5 Year Warranty



2 LAMP WIRING DIAGRAM

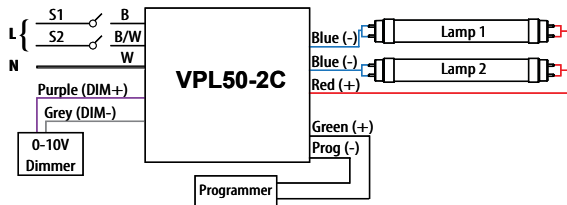

Light Level	S1	S2
100%	ON	ON
50%*	ON	OFF
25%*	OFF	ON
0%	OFF	OFF

*Programmable For Dual-Relay Dimming

4 LAMP WIRING DIAGRAM

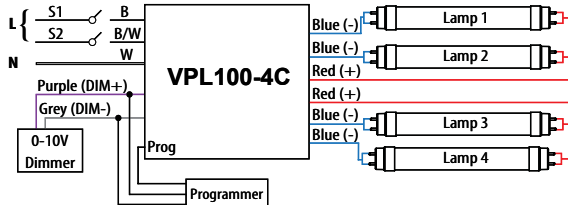

Light Level	S1	S2
100%	ON	ON
50%*	ON	OFF
25%*	OFF	ON
0%	OFF	OFF

*Programmable For Dual-Relay Dimming

Model No.	Output Current	Driver Type	Max Wattage (W)	No. of Channels	Input Voltage (V)	Dimming
Programmable LED Driver						
VPL50-2C	Programmable	Constant Current	50	2	120 - 277	0 - 10V or A/B
VPL100-4C	Programmable	Constant Current	80	4	120 - 277	0 - 10V or A/B

See espentech.com for CoreTech™ and VersaLinear™ specifications.

LED LAMPS



Field Adjustable LED Driver for Type-C LED's | Type C



FEATURES AND BENEFITS

- Programmable Drive Current Range (300/600mA)
- For Use with 1 or 2 Espen CoreTech™ LED T5 or T8 Lamps
- Constant Current | 2 Channels
- Output Voltage: 20-46V DC
- Universal Voltage (120 - 277V)
- Dimmable
- Suitable for Damp Locations
- 5 Year Warranty



- Programmable Drive Current Range (300/360mA)
- For Use with 3 or 4 Espen CoreTech™ LED T5 or T8 Lamps
- Constant Current | 4 Channels
- Output Voltage: 20-46V DC
- Universal Voltage (120 - 277V)
- Dimmable
- Suitable for Damp Locations
- 5 Year Warranty



2 LAMP WIRING DIAGRAM

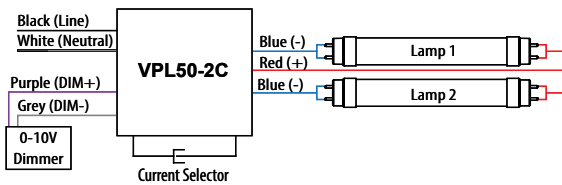

Current Selector Close = (300mA)

4 LAMP WIRING DIAGRAM

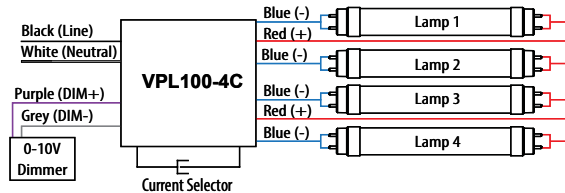

Current Selector Open = (360mA)

Model No.	Output Current	Driver Type	Max Wattage (W)	No. of Channels	Input Voltage (V)	Dimming
Programmable LED Driver						
VPL50-2C-030/036	Field Adjustable	Constant Current	33	2	120 - 277	0-10V
VPL100-4C-030/036	Field Adjustable	Constant Current	66	4	120 - 277	0-10V

See espentech.com for CoreTech™ and VersaLinear™ specifications.

LED LAMPS



LED Modules | Type C

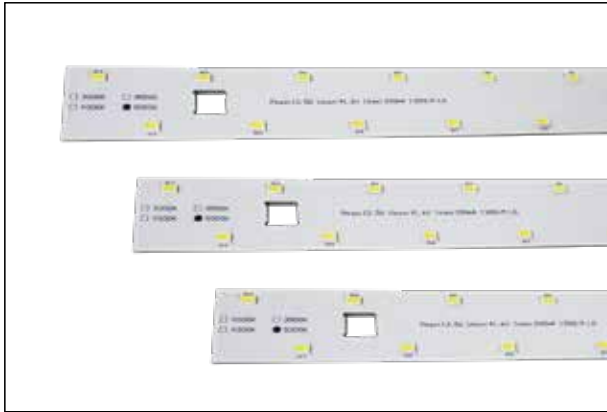

FEATURES AND BENEFITS

- High Efficacy
- Push-In Connectors
- Long Life
- Consistent and Even Light Distribution
- Flexibility in Design
- Consistent and Even Light Distribution
- Thermally Independent
- Suitable for DLC Applications
- UL for Safety: UL1598C for LED Retrofit Kits
- 5 Year Warranty



Model No.	Lumen	CCT	CRI	SDCM	Driving Current (mA)	P (W) Module Tc 55°C	Im. W* Module Tc 55°C	L70 B50 (h)
VLM11L/250/830/2R/530X30	1800	3000	>80	6	250	11	150	50000
VLM11L/250/835/2R/530X30	1800	3500	>80	6	250	11	150	50000
VLM11L/250/840/2R/530X30	1800	4000	>80	6	250	11	150	50000
VLM11L/250/850/2R/530X30	1800	5000	>80	6	250	11	150	50000
VLM13L/500/830/2R/482X30	2400	3000	>80	6	500	18	130	50000
VLM13L/500/835/2R/482X30	2400	3500	>80	6	500	18	130	50000
VLM13L/500/840/2R/482X30	2400	4000	>80	6	500	18	130	50000
VLM13L/500/850/2R/482X30	2400	5000	>80	6	500	18	130	50000

* Eligible for DLC when built in a luminaire. Please contact Customer Service for more

Advance LED Drivers | CoreTech™

Espen's extensive range of advanced LED drivers offer:

- Constant current or constant voltage
- 0-10V or triac dimming options
- UL listed or recognized
- Advance thermal management for long life
- Multiple case options
- Protections: short circuit, open, circuit, overload, and overheat
- 5-Year warranty



FOR MORE DRIVER OPTIONS
PLEASE CHECK OUR ESPEN DRIVER CATALOG



LED RETROFIT KITS

versaLinear™ LED Linear Module Retrofit Kits



FEATURES AND BENEFITS

- Designed to Achieve High Lumen Output
- Each Kit Includes LED Modules Paired with an LED Driver
- LED Modules Feature Durable Aluminium Structures
- Magnetic Backing for Easier Installation
- Available with Frosted Diffuser Lens or No Diffuser Lens
- Kits Retrofit 2, 3 and 4 foot T5 and T8 Fixtures
- -20° F to 130° F Ambient Operating Temperature
- End-to-End Lighting with No Dark Spots
- 120 - 277V Input Voltage
- 80+ CRI
- 50,000 Hours Life
- Dimmable
- 5 Year Warranty



2 LAMP WIRING DIAGRAM

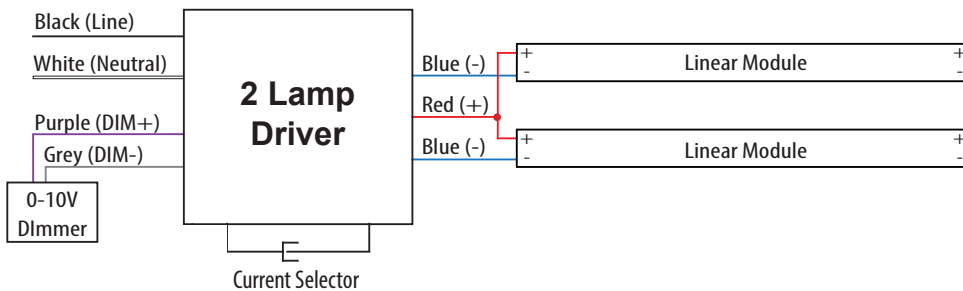

4 LAMP WIRING DIAGRAM

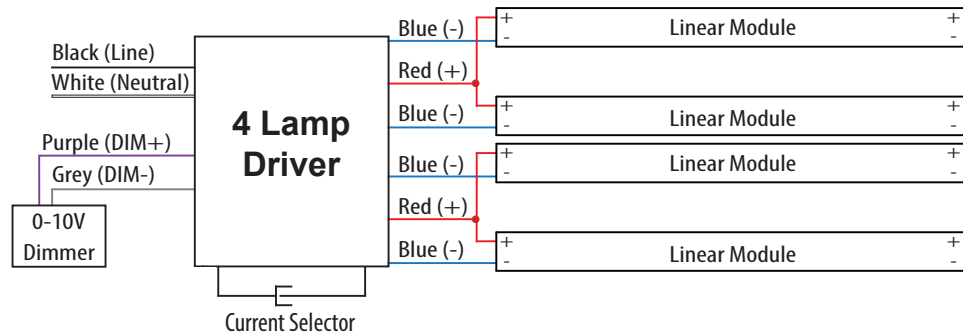

LED RETROFIT KITS

versaLinear™ LED Linear Module Retrofit Kits

Espen Model No.	DLC Model No.	Replaces	Diffuser Lens	No. of Modules Included	Driver Included	Driver Current	System Power (W)	System Lumens (lm)	System Efficacy (lm/W)
2 Foot HE - High Efficiency									
VEKM-L21C/8XX ^{1,2}	D546-1M-302C	1 x F17T8	No	1	VPL50	High Normal	12 10	1500 1250	125 125
VEKM-L21F/8XX ^{1,2}	D546-1M-302F	1 x F17T8	Yes	1	VPL50	High Normal	12 10	1250 1050	104 105
VEKM-L22C/8XX ^{1,2}	D546-2M-302C	2 x F17T8	No	2	VPL50	High Normal	24 20	3000 2500	125 125
VEKM-L22F/8XX ^{1,2}	D546-2M-302F	2 x F17T8	Yes	2	VPL50	High Normal	24 20	2550 2100	105 105
VEKM-L23C/8XX ^{1,2}	D547-3M-302C	3 x F17T8	No	3	VPL100	High Normal	34 28	4300 3600	126 129
VEKM-L23F/8XX ^{1,2}	D547-3M-302F	3 x F17T8	Yes	3	VPL100	High Normal	34 28	3550 3000	104 107
VEKM-L24C/8XX ^{1,2}	D547-4M-302C	4 x F17T8	No	4	VPL100	High Normal	43 36	5600 4700	130 131
VEKM-L24F/8XX ^{1,2}	D547-4M-302F	4 x F17T8	Yes	4	VPL100	High Normal	43 36	4600 3900	107 108
3 Foot HE - High Efficiency									
VEKM-L31C/8XX ^{1,2}	D546-1M-303C	1 x F25T8	No	1	VPL50	High Normal	16 13	2100 1750	131 135
VEKM-L31F/8XX ^{1,2}	D546-1M-303F	1 x F25T8	Yes	1	VPL50	High Normal	16 13	1700 1400	106 108
VEKM-L32C/8XX ^{1,2}	D546-2M-303C	2 x F25T8	No	2	VPL50	High Normal	32 26	4250 3500	133 135
VEKM-L32F/8XX ^{1,2}	D546-2M-303F	2 x F25T8	Yes	2	VPL50	High Normal	32 26	3400 2800	106 108
VEKM-L33C/8XX ^{1,2}	D547-3M-303C	3 x F25T8	No	3	VPL100	High Normal	46 38	6100 5000	133 132
VEKM-L33F/8XX ^{1,2}	D547-3M-303F	3 x F25T8	Yes	3	VPL100	High Normal	46 38	5050 4200	110 111
VEKM-L34C/8XX ^{1,2}	D547-4M-303C	4 x F25T8	No	4	VPL100	High Normal	60 50	8000 6500	133 130
VEKM-L34F/8XX ^{1,2}	D547-4M-303F	4 x F25T8	Yes	4	VPL100	High Normal	60 50	6500 5400	108 108

¹ XX = 30, 35, 40 or 50
30 = 3000K, 35 = 3500K, 40 = 4000K and 50 = 5000K (3000K may be subject to lead times and availability.)

² Not DLC listed. See 4 foot modules for DLC listed modules.

LED RETROFIT KITS

versaLinear™ LED Linear Module Retrofit Kits

Espen Model No.	DLC Model No.	Replaces	Diffuser Lens	Quantity of Modules Included	Driver Included	Drive Current	System Power (W)	System Lumens (lm)	System Efficacy (lm/W)
4 Foot HE - High Efficiency									
VEKM-L41C/8XX ^{1,2}	D546-1M-304C	1 x F32T8	No	1	VPL50	High	18	2300	128
						Normal	14	1850	132
VEKM-L41F/8XX ^{1,2}	D546-1M-304F	1 x F32T8	Yes	1	VPL50	High	18	1850	103
						Normal	14	1550	111
VEKM-L42C/8XX ^{1,3}	D546-2M-304C	2 x F32T8	No	2	VPL50	High	35	4600	131
						Normal	27	3700	137
VEKM-L42F/8XX ^{1,3}	D546-2M-304F	2 x F32T8	Yes	2	VPL50	High	35	3900	111
						Normal	27	3100	115
VEKM-L43C/8XX ^{1,2}	D547-3M-304C	3 x F32T8	No	3	VPL100	High	50	6900	138
						Normal	39	5550	142
VEKM-L43F/8XX ^{1,2}	D547-3M-304F	3 x F32T8	Yes	3	VPL100	High	50	5850	117
						Normal	39	4600	118
VEKM-L44C/8XX ^{1,4}	D547-4M-304C	4 x F32T8	No	4	VPL100	High	65	9250	142
						Normal	51	7400	145
VEKM-L44F/8XX ^{1,4}	D547-4M-304F	4 x F32T8	Yes	4	VPL100	High	65	7800	120
						Normal	51	6150	121
4 Foot HO - High Output									
VEKM-L41C/HO/8XX ^{1,2}	D546-1M-304C/HO	1 x 4'HO	No	1	VPL50	Normal	26	4000	150
VEKM-L41F/HO/8XX ^{1,2}	D546-1M-304F/HO	1 x 4'HO	Yes	1	VPL50	Normal	26	3400	130
VEKM-L42C/HO/8XX ^{1,2}	D547-2M-304C/HO	2 x 4'HO	No	2	VPL100	Normal	52	8000	150
VEKM-L42F/HO/8XX ^{1,2}	D547-2M-304F/HO	2 x 4'HO	Yes	2	VPL100	Normal	52	6800	130
4 Foot VHO - Very High Output									
VEKM-L41C/VHO/8XX ^{1,2}	D547-1M-304C/VHO	1 x 4'VHO	No	1	VPL100	Normal	52	8200	155
VEKM-L41F/VHO/8XX ^{1,2}	D547-1M-304F/VHO	1 x 4'VHO	Yes	1	VPL100	Normal	52	7000	135

¹ XX = 30, 35, 40 or 50
30 = 3000K, 35 = 3500K, 40 = 4000K and 50 = 5000K (3000K may be subject to lead times and availability.)
² Not DLC listed. See 4 foot modules for DLC listed modules.

³ DLC listed.
⁴ DLC pending.

Emergency Back-Up Kits

Constant Wattage LED



FEATURES AND BENEFITS

- Constant Wattage & Light Output
- High Efficacy LED Module
- Does not Affect Existing Lighting Fixture / Luminaire
- UL Listed

DIMENSIONS

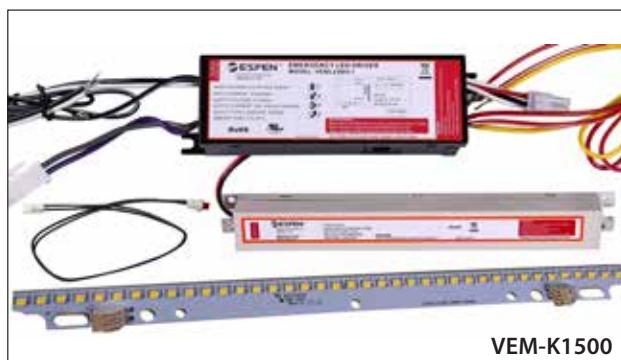
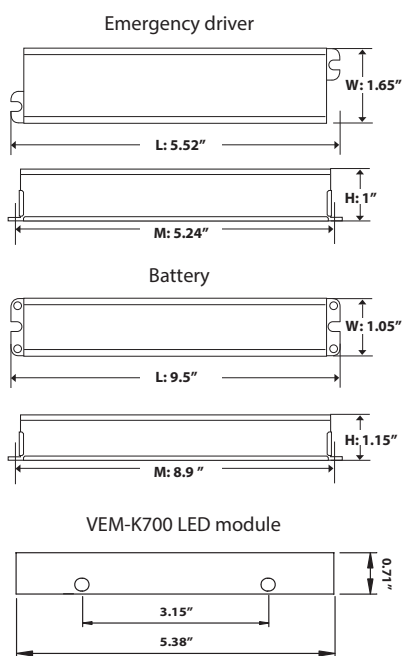

WIRING DIAGRAM

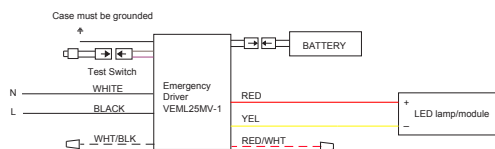

Model #	Dip Switch Setting	Emergency Mode Output Power	Emergency Mode Output Voltage	Emergency Mode Output Current	Battery Charging Current
VEM-K700		5W	12-50V	416-100mA	60mA
VEM-K1500		10W	12-50V	830-200mA	100mA

Model No.	Lumens (90min)	Wattage	Module Information
VEM-K700	700lm	5W	VLM0605L/850 5W, 5000K, CRI80
VEM-K1500	1500lm	10W	VLM1207L/850 10W, 5000K, CRI80

LED EMERGENCY BATTERY BACK UP

LED
MODULES

LED
DRIVERS

LED
DRIVER CASES

LED
LAMPS

LED
RETROFIT KITS

LED EMERGENCY
BATTERY BACK UP

STEP-DOWN
TRANSFORMERS

CONTROL
OPTIONS

Sentinel® EMERGENCY DRIVERS



FEATURES AND BENEFITS

- Constant wattage & light output
- Auto LED load sensing
- Universal Input (120-277V)
- Complete Thermal Solution
- Heavy duty battery
- Programmable for Lumen Output
- UL Recognized



Wiring Diagram:

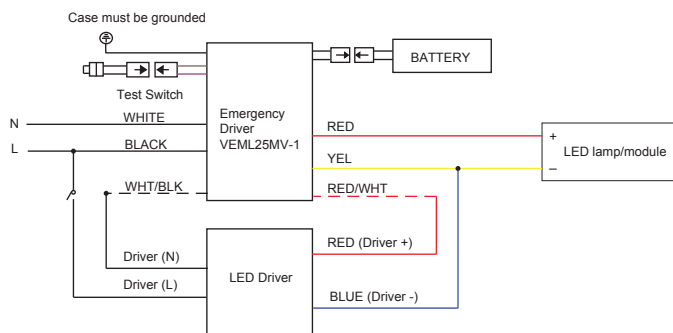

Wattage Adjustment (dip switch):

Dip Switch Setting	Emergency Mode Output Power	Emergency Mode Output Voltage	Emergency Mode Output Current	Battery Charging Current
	5W	12-50V	416-100mA	60mA
	10W	12-50V	830-200mA	100mA
	15W	12-50V	1250-300mA	160mA
	20W (VEML20MV-1) 25W (VEML25MV-1)	12-50V	1400-400mA 2084-500mA	210mA

Model No.	Battery Package	Max Load for 90 Min
Emergency LED Driver		
VEML20MV-1	BA/96L/1.0AH	5W
	BA/96L/2.0AH	10W
	BA/96L/3.0AH	15W
	BA/96L/6.0AH	20W
VEML25MV-1	BA/96L/1.0AH	5W
	BA/96L/2.0AH	10W
	BA/96L/6.0AH	25W



Model No.	Description
EML25-PLATE	Emergency driver back plate Pre-wired and mounted emergency driver and battery unit in one plate.

LED EMERGENCY BATTERY BACK UP

LED
MODULES

LED
DRIVERS

LED
DRIVER CASES

LED
LAMPS

LED
RETROFIT KITS

LED EMERGENCY
BATTERY BACK UP

STEP-DOWN
TRANSFORMERS

CONTROL
OPTIONS

Sentinel® EMERGENCY INVERTERS



VEMB20W
20W



VEMB5W
5W

FEATURES AND BENEFITS

- Operates Espen Type B T5 & T8 LED Lamps
- Illuminates Most LEDs at Full Brightness, Up to 20W
- 32° F to 122° F Ambient Operating Temperature
- Durable Steel Housing Contains LED Driver & Battery
- Suitable for Damp Locations
- 90 Minute Illumination Time
- Nickel-Cadmium Rechargeable Battery
- LED Test Switch Included
- UL924, NFPA 101 Life Safety Code, NEC & OSHA Compliant
- 5 Year Warranty

FEATURES AND BENEFITS

- Operates Espen Type B T5 & T8 LED Lamps
- Provides 5W of power for a minimum of 90 minutes
- 32° F to 122° F Ambient Operating Temperature
- Durable Steel Housing Contains LED Driver & Battery
- Suitable for Damp Locations
- Lithium-Ion Rechargeable Battery
- LED Test Switch Included
- UL924 & FCC Compliant
- 5 Year Warranty



DIMENSIONS

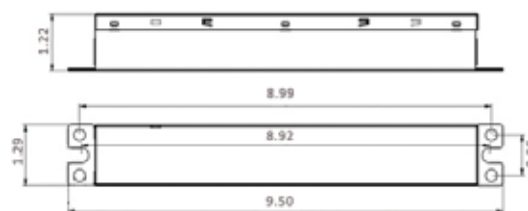
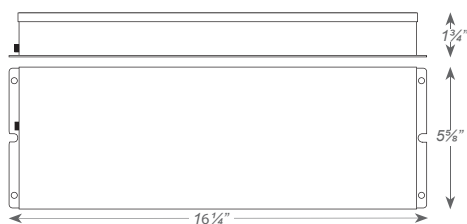

WIRING DIAGRAM

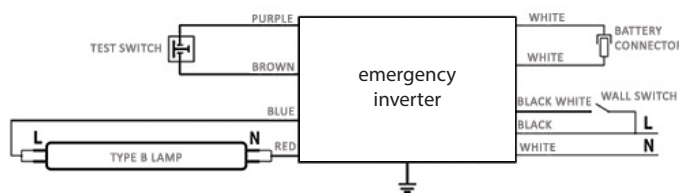
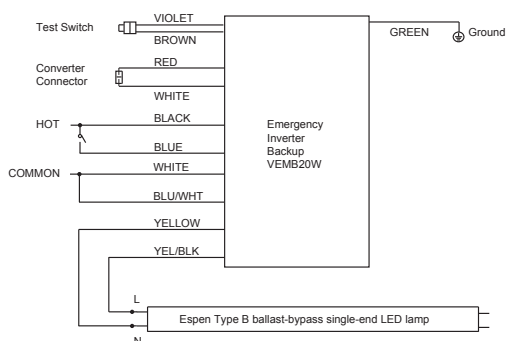

Model No.	Input Voltage (V)	Output Voltage (V)	Output Power (W)
Type B Emergency LED Driver			
VEMB20W+	120-277	OCV 320VDC	20
VEMB5W	120-277	OCV 300VDC	5

STEP-DOWN TRANSFORMERS

LED
MODULES

LED
DRIVERS

LED
DRIVER CASES

LED
LAMPS

LED
RETROFIT KITS

LED EMERGENCY
BATTERY BACK UP

STEP-DOWN
TRANSFORMERS

CONTROL
OPTIONS

PRODUCT FEATURES

- Non-isolated autotransformer
- UL listed
- Thermally protected (auto reset)
- Max case temperature 105C
- Sound rated A
- 5 year limited warranty
- Designed for lighting applications
 - LED
 - Electronic ballasts
 - HID
- Low profile cases

Model Number	Input			Output		Physical Properties	
	Voltage	Current at Max Load	Power at Max Load	Output Voltage	Max Load (VA)	Case	Wiring Diagram
VETR480/277-60VA	480/347	0.125/0.172	66W	277/240	60	A	WD-1
VETR480/277-110VA	480/347	0.229/0.317	125W	277/240	110	B	WD-1
VETR480/277-250VA	480/347	0.520	275W	277/200	250/180	B	WD-2
VETR480/277-375VA	480/347	0.781	410W	277/200	375/270	C	WD-2

APPLICATION NOTES

- Supply current frequency 60Hz
- Do not use on ungrounded systems

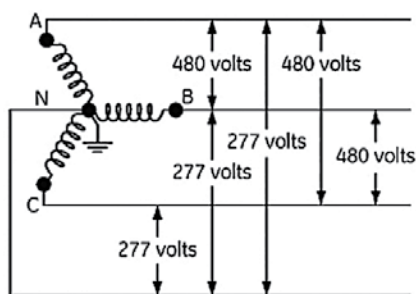

WYE

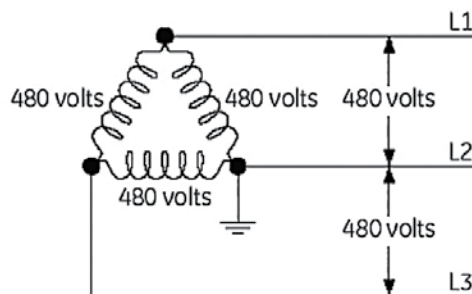

DELTA

Why do we use VA instead of watts

Why do we use VA instead of Watts when setting Step-Down Transformer loads?

The power in watts is the real power drawn by the equipment. Volt-Amps (VA) are called the “apparent power” and is the product of the voltage applied to the equipment times the current drawn by the equipment.

*Use one of these formulas to determine the missing quantity:

$$\text{Watts} = \text{VA} \times \text{Power factor} \text{ or } \text{VA} = \text{Watts} / \text{Power Factor}$$

*For example to find VA of a 240W load with a .98PF is $240 / .98 = 244\text{VA}$ for sizing your Step-Down Transformer

STEP-DOWN TRANSFORMERS

PHYSICAL PARAMETERS

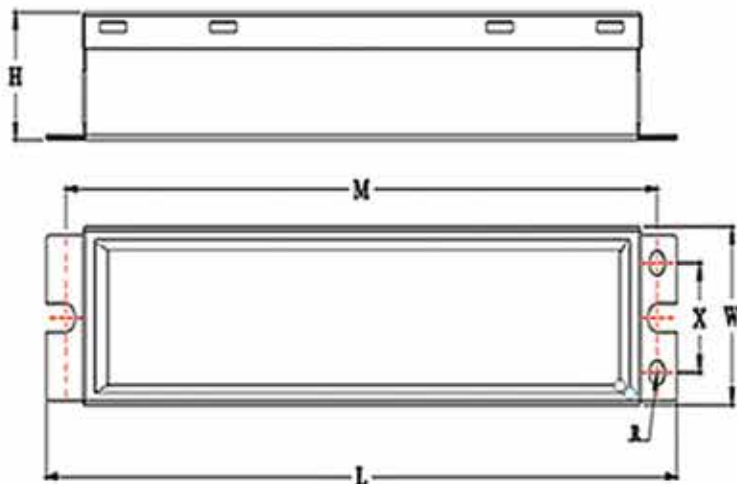

CASE DIMENSIONS IN INCHES			
Case	A	B	C
L	7.20	9.49	11.70
M	6.61	8.90	11.14
W	1.73	1.73	1.73
X	1.06	1.06	1.06
H	1.30	1.30	1.30
R	1.30	1.30	1.30
Lead Lengths	15"/16AWG	14"/16AWG	14"/16AWG

WIRING DIAGRAMS

WD-1

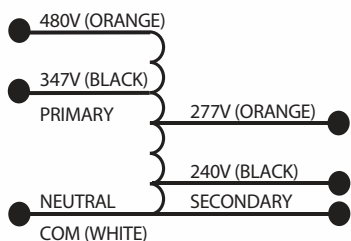

VETR480/277-60VA & VETR480/277-110VA
Cap all unused wires

WD-2

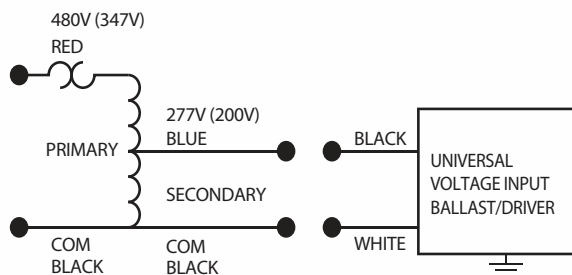

VETR480/277-250VA & VETR480/277-375VA



CONTROL OPTIONS

LED MODULES

LED DRIVERS

LED DRIVER CASES

LED LAMPS

LED RETROFIT KITS

LED EMERGENCY BATTERY BACKUP

STEP-DOWN TRANSFORMERS

CONTROL OPTIONS

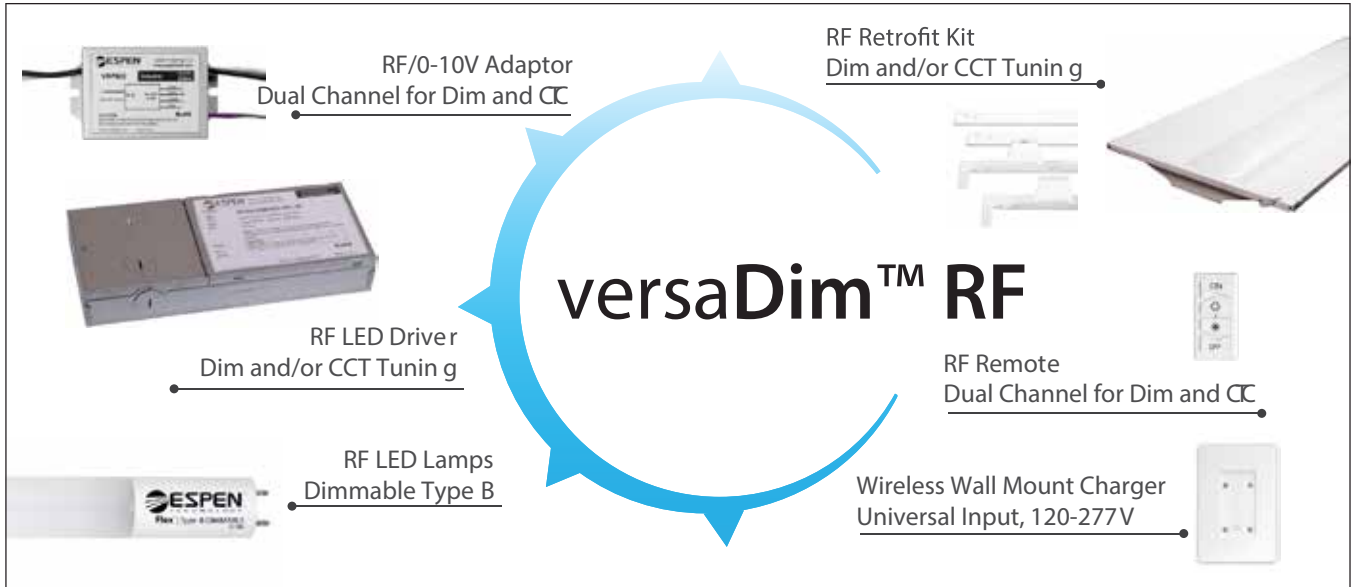

FEATURES AND BENEFITS

- Dual Channel for Dimming and CCT Tuning
- Wall Mount Wireless Charger
- Adapter to Convert Current Fixtures to RF
- Dual Channel Drivers for New Fixtures
- Dimmable Type B Lamps
- Universal 120-277V Input
- Capable of Zoning Control
- Emergency Switch
- Highly Secure System
- UL Certified

How it works

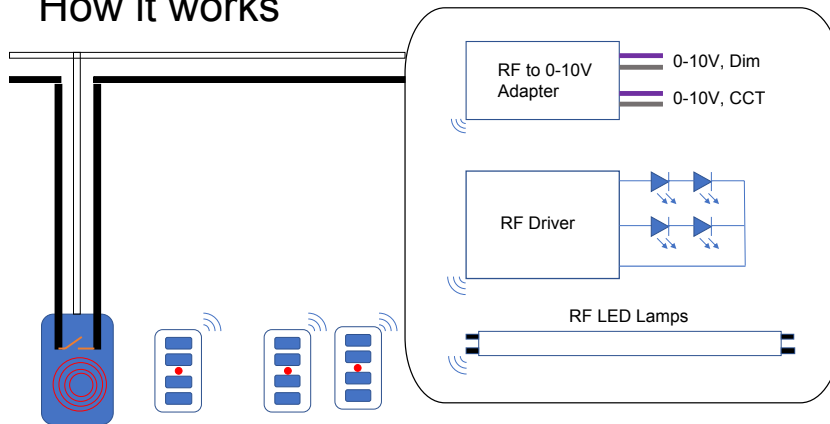

The versaDim™ RF System solves the problem of overly complex and expensive wireless controls. The system enables simple, low-cost dimming and CCT selection using a handheld RF remote. The remote has a wall dock that wirelessly recharges the remote.

PRODUCT SPECIFICATIONS

OCCUPANCY SENSOR

360° HIGH BAY PASSIVE INFRARED (PIR) FIXTURE MOUNT

FMH-6A-MV (UM)



SPECIFICATIONS

Voltage:	120/277VAC, 60 Hz
Load Requirement:	800VA @120VAC* 1200VA @277VAC* * Fluorescent Ballasts No Min
Load Horsepower:	1/6HP
Time Delay Adjustment:	Fixed 15 seconds to 30 minutes
Operating Temperature:	32° to 131° F (0° to 55° C)
Humidity Range:	0% to 90% RH, non-condensing
Coverage Range:	High Bay mounting heights up to 30 ft mounting/360° field
Terminal Line:	Black - Hot, White - Neutral, Red - Load

The FMH-6A-MV (UM) Occupancy Sensor is designed to mount directly onto a luminaire and is ideal for high mounted areas such as warehouses, manufacturing facilities, and other high ceiling applications.

Other mounting options include: Ceiling mount, J-Box Mount

OPERATION

The sensor detects changes in the infrared energy given off by occupants as they move within the field-of-view. When occupancy is detected, a self-contained relay switches the connected lighting load on. The sensor is line powered and can switch line voltage. An internal timer, factory set at 15 seconds, keeps the lights on during brief periods of inactivity.

OPERATIONAL MODES

Auto ON, Auto OFF

COVERAGE AREA

Best choice for 15 to 30 ft mounting heights. 15 to 20 ft radial coverage overlaps area lit by a typical high bay fixture (refer to Fig. A)

TYPICAL APPLICATIONS

- Warehouses
- Gymnasiums
- Manufacturing Facilities
- Industrial Facilities

FEATURES

- PIR Occupancy Detection
- Self Contained Relay, no Power Pack needed
- Adjustable Time Delay: 15 sec - 30 mins
- Frequency: 50/60Hz
- UL, cUL
- CA Title 24 Compliant
- 5 Year Warranty

WIRING DIAGRAMS

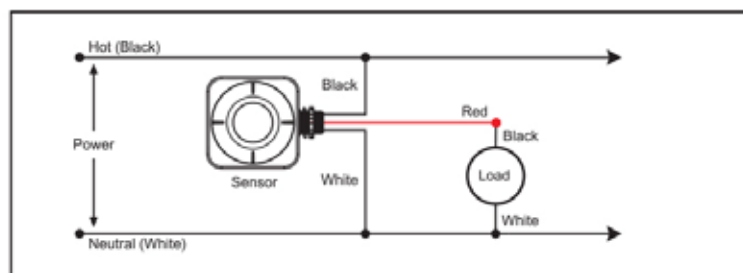



the **Power** to Create Better Light™

OEM PRODUCT GUIDE

HEADQUARTERS

Espen Technology Inc.
12257 Florence Ave
Santa Fe Springs, CA 90670, USA

WAREHOUSE

Espen Technology Inc.
1350 Brookville Way, Suite F
Indianapolis, IN 46239, USA

SALES/CUSTOMER SERVICE

Toll Free Tel.: (866) 933-7736
Toll Free Fax: (888) 503-7736
Tel.: (562) 529-2938
Fax: (562) 529-2978

CONNECT:



facebook.com/espentech
twitter.com/espentech
youtube.com/espentechnology
linkedin.com/company/espen-technology
instagram.com/espentechnology

EMAIL

info@espentech.com

WEBSITE

www.espentech.com

© 2019 Espen Technology, Inc.

All rights reserved. Reproduction in whole or part is prohibited without the prior written consent of the copyright owner. The information presented in this document does not form part of any quotation or contract, is believed to be accurate and reliable and may be changed without notice. No liability will be accepted by the publisher for any consequence of its use.

ESOEM0419